

The Third Xiamen Symposium on Marine Environmental Sciences



January 9-11, 2017
Xiamen University, China

CONTENT

Introduction	1
Important Information	2
Symposium Venue	2
Registration.....	2
Icebreaker	2
Organized Events.....	2
Meals and Tea Breaks.....	3
Shuttle Bus Arrangements	5
Presentation Guidelines	6
Sessions and Workshops.....	7
Program	10
Floor Plan	10
Program Layout	13
Program	16
Poster List.....	39
Local Information and Contacts.....	54
Venue	54
Housing	57
Wi-Fi Connection Instructions.....	58
Contacts for Logistics	58
Exhibitions	59
Symposium Evaluation	66

Introduction

To foster knowledge and ideas exchange within the marine environmental science community and, in particular, to promote interdisciplinary studies, the State Key Laboratory of Marine Environmental Science (MEL, <http://mel.xmu.edu.cn/en>) of Xiamen University initiated the Xiamen Symposium on Marine Environmental Sciences (XMAS), with the overarching theme **The Changing Ocean Environment: From a Multidisciplinary Perspective**. The first two symposia (<http://mel.xmu.edu.cn/conference/1xmas>, <http://mel.xmu.edu.cn/conference/2xmas>) were held in Jan 2014 and Jan 2015, attracting over 800 participants from more than 100 institutions across 14 countries.

The third iteration, XMAS2017 (<http://mel.xmu.edu.cn/conference/3xmas>), will be held in Xiamen from January 9th to 11th, 2017. The symposium will consist of different, interconnected sessions covering physical oceanography, marine biogeochemistry, biological oceanography, and marine ecotoxicology along with workshops for emerging topics in marine environmental sciences.

Organizers and Sponsors

State Key Laboratory of Marine Environmental Science (Xiamen University)
Department of Earth Sciences, National Natural Science Foundation of China

Co-sponsors

State Key Laboratory in Marine Pollution (City University of Hong Kong)
Campus do Mar, Vigo, Spain
The Swire Institute of Marine Science, The University of Hong Kong
Villefranche Oceanographic Laboratory, University of Paris VI, France
College of Earth, Ocean, and Environment, University of Delaware, USA
State Key Laboratory of Satellite Ocean Environment Dynamics, Second Institute of Oceanography, State Oceanic Administration
Yantai Institute of Coastal Zone Research, Chinese Academy of Sciences
Marine Chemistry Section, Chinese Society for Oceanography

Scientific Advisory Committee

Chair: Minhan Dai

Members: Weijun Cai, Wenju Cai, Fei Chai, Jianping Gan, Toshiyuki Hibiya, David Hutchins, Nianzhi Jiao, Paul Lam, Cindy Lee, Louis Legendre, James W. Murray, Bayden Russell, Dalin Shi, Emilio Fernández Suárez

Local Organizing Committee

Chair: Dalin Shi

Member: Zhimian Cao, Xiaolin Li, Zhiyu Liu, Yawei Luo, Xiaoyi Yang

Important Information

Symposium Venue

XMU Science and Arts Center, Siming Campus, Xiamen University, Xiamen, China

厦门大学思明校区科学艺术中心

Registration

Jan 8: 1600-2100 Venue: Luyuan Hall, Millennium Harbourview Hotel (2nd Floor)

海景千禧酒店鹭园厅

Jan 9-10: 0730-1830 Venue: Lobby, XMU Science and Art Center (2nd floor)

厦门大学科学艺术中心

Icebreaker

Jan 8: 1800-2100 Venue: Luyuan Hall, Millennium Harbourview Hotel (2nd Floor)

海景千禧酒店鹭园厅

Organized Events

1. Open Discussion Session on Publication Practice in JGR-Oceans

Dr. Peter Brewer is going to hold this open discussion session for young researchers. He will share his experience as Editor-in chief and talk about how to write a paper and get it published in a scientific journal.

Convened by Dr. Peter Brewer, Editor-in-chief, Journal of Geophysical Research-Oceans

Assistant: Dr. Xiaolin Li, Xiamen University

Time: 1255-1355 Jan 9

Venue: Multifunction Hall (1st Floor) (多功能厅)

2. Student Activities

Student Night

Several invited scientists will share their lives and career experiences with students, such as their first papers, first job interviews, the best or the most difficult moments in career, and their lives as scientists. Light food and drink will be provided.

Time: 1830-2030 Jan 9

Venue: Jian-Wen Building Cafe (200 m from the symposium venue) (建文楼咖啡厅)

Student Award

Four best student posters will be selected. First place will receive a 3-month scholarship jointly sponsored by MEL (XMU) and SWIMS (HKU), supporting the student to conduct research at either MEL or/and SWIMS, including travel, accommodation and a stipend. Each of the other three awardees will receive a prize of 5,000 RMB provided by MEL. Students are expected to present their posters to the judges during the poster sessions.

3. Women in Science Salon

While the ratio of female to male students in ocean and environmental sciences fields have steadily increased over the years, the number of female scientists within the higher tiers of science remains disappointingly low. Join several leading women in the field in an open discussion about the opportunities and challenges specific to women in science. Hosted by Anne McElroy, Anja Engel, Ann Pearson, Mingfang Ting, Mary Jane Perry, and Robin Robertson

Time: 1700-1830 Jan 10

Venue: Multifunction Hall (1st Floor) (多功能厅)

Meals and Tea Breaks

Date	Event	Time	Venue
Jan 8	Icebreaker	1800-2100	Luyuan Hall (2nd floor) Millennium Harbourview Hotel 海景千禧酒店鹭园厅
Jan 9	Tea Break	0950-1010	Exhibition Hall (1st floor) & Lobby (2nd floor) 展厅&大厅
	Lunch	1215-1400	Qinye Canteen 勤业餐厅
	Poster Session I (Light refreshments)	1625-1830	Exhibition Hall (1st floor) 展厅
Jan 10	Tea Break	1010-1030	Exhibition Hall (1st floor) & Lobby (2nd floor) 展厅&大厅
	Lunch	1230-1400	Qinye Canteen 勤业餐厅
	Poster Session II (Light refreshments)	1625-1830	Exhibition Hall (1st floor) 展厅
	Dinner	1930-2130 (Buses leave at 1840)	Rongyu Seafood Restaurant (Near Haiwan Park) 荣誉酒店(海湾公园店)
Jan 11	Tea Break	1010-1030	Exhibition Hall (1st floor) & Lobby (2nd floor) 展厅&大厅
	Lunch	1230-1400	Qinye Canteen 勤业餐厅
	Tea Break	1605-1630	Exhibition Hall (1st floor) & Lobby (2nd floor) 展厅&大厅

Restaurants

Dinning around Xiamen University's Siming Campus is very convenient. Restaurants, cafés and bars can be easily found at Da Xue Road, Ding Ao Zai Road, Sha Po Wei and within shopping malls along these roads.



Forward Mall 富万邦商业广场 (across the street from the West Gate)

- (1) Teng Long Pavilion 腾龙阁餐厅 (fourth floor; 0592-2069216)
- (2) Two Tomato 两个番茄 (fourth floor; 0592-5591314)
- (3) KFC 肯德基 (first floor)
- (4) MacDonald 麦当劳 (second floor)

Ding Ao Zai Road 顶澳仔路 (8 mins walk from the West Gate)

- (1) Zhu House 助屋 (39 Ding Ao Zai road)
- (2) Champion Pizza 千尊披萨 (18-14 Ding Ao Zai road; 0592-2088776)
- (3) Cai Jia Po 蔡家坡 (21 Ding Ao Zai road; 0592-2086765)

Xiamen Shimao Shopping Mall 厦门世茂大厦 (10 mins walk distance from the West Gate)

- (1) You Go COCO ZONE 芭缇沁园椰子鸡 (third floor; 0592-2085562)
- (2) 70 Restaurant 柒零主题餐厅 (fourth floor; 0592-5751170)
- (3) North Xinjiang restaurant 北疆饭店旗舰店 (fourth floor; 0592-7165711)
- (4) Yoko Machi Ramen Shop 横町拉面 (fourth floor; 0592-8268331)
- (5) Taoxiang Hot pot 陶乡火锅 (fourth floor; 0592-5807370)

Da Xue Road 大学路 (8 mins walk distance from the West Gate)

- (1) 4 people (106 Da Xue Road; 0592-2191963)
- (2) Bravo Burger+百万万汉堡店 (129 Da Xue Road; 15160032305)
- (3) DaoJu House 道居食屋 (122 Da Xue Road; 0592-5698881)
- (4) Thank You Cafe (162 Da Xue Road; 0592-2082609)
- (5) Now Cafe 闹咖啡 (160 Da Xue Road; 0592-2090978)

Sha Po Wei 沙坡尾 (20 mins walk distance from the West Gate)

- (1) Minggu Indonesian cuisine 鸣谷印尼料理 (155 Min Zu Road; 0592-2068133)
- (2) Pacific Coffee (50 Min Zu Road; 0592-2120815)
- (3) Route 65 Tacos (191 Min Zu Road; 18750939820)

Shuttle Bus Arrangements**Buses on Jan 8 for Icebreaker at Millennium Harborview Hotel**

Date	Departure	From	To
Jan 8	1600	Green Tree Inn	Millennium Harborview Hotel
	1630	Zhou Long Quan Building	Millennium Harborview Hotel
	1700	XMU Campus Hotels	Millennium Harborview Hotel
	2100	Millennium Harborview Hotel	Green Tree Inn
	2100	Millennium Harborview Hotel	XMU Campus Hotels
	2100	Millennium Harborview Hotel	Zhou Long Quan Building

Note: No bus provided for participants living in Swiss International Hotel. It is about 5 minutes walk distance to Millennium Harborview Hotel.

Shuttle bus provided by Millennium Harborview Hotel

Date	Departure	From	To
Jan 9	0740	Millennium Harborview Hotel	Symposium venue
	1840	Symposium venue	Millennium Harborview Hotel
Jan 10	0750	Millennium Harborview Hotel	Symposium venue
	2130	Rongyu Restaurant	Millennium Harborview Hotel
Jan 11	0750	Millennium Harborview Hotel	Symposium venue
	1840	Symposium venue	Millennium Harborview Hotel

Buses on Jan 10 for Conference Dinner

Date	Departure	From	To
Jan 10	1840	Symposium venue	Rongyu Seafood Restaurant
	2130	R1: Rongyu Seafood Restaurant	Millennium Harborview Hotel & Swiss International Hotel
	2130	R2: Rongyu Seafood Restaurant	XMU West Gate (for Green Tree Inn & XMU Campus Hotels)
	2130	R3: Rongyu Seafood Restaurant	Zhou Long Quan Building

Shuttle bus for XMU students on Xiang'an Campus

Date	Departure	From	To
Jan 8	1630	Zhou Long Quan Building	Millennium Harborview Hotel
	2100	Millennium Harborview Hotel	Zhou Long Quan Building
Jan 9	0710	Zhou Long Quan Building	Symposium venue
	1840	Symposium venue	Zhou Long Quan Building
	2030	Jan-Wen Building Cafe	Zhou Long Quan Building
Jan 10	0720	Zhou Long Quan Building	Symposium venue
	2130	Rongyu Seafood Restaurant	Zhou Long Quan Building
Jan 11	0720	Zhou Long Quan Building	Symposium venue
	1840	Symposium venue	Zhou Long Quan Building

Presentation Guidelines

Oral Presentations

- ✧ Keynote speeches are 40 minutes each including ~5 minutes Q&A.
- ✧ Other talks are scheduled for 15- to 25-minute time slots depending on the sessions. We strongly encourage a presentation to allow at least 3 minutes for discussion and to entertain questions from those in the audience. The time limit will be strictly enforced to facilitate movement between sessions.
- ✧ No audio or video recording is allowed in any of the session rooms during the meeting.
- ✧ Presentations should be in Microsoft PowerPoint (.ppt or .pptx). Please notify the technician in the room in which your presentation will take place well in advance if your presentation is in a different format.
- ✧ Please bring your presentation on a USB memory stick. Be sure to CLEARLY identify your USB memory stick with your name & the session in which you are presenting.
We recommend all PPT files be uploaded upon registration at 1600h-2100h on Jan 8, or at the beginning of each day, before the speaker sessions, please submit your presentation media to the session chair (or conference staff) in the room in which your presentation will take place. The session chair (or conference staff) will help you load your presentation on to the appropriate computer.

***Please be sure to check your presentation for viruses before
uploading and presenting at the meeting.***

Poster Presentations

- ✧ The designated poster sessions are from 1625h-1830h on Monday and Tuesday (Jan 9 and Jan 10) in the Exhibition Hall (first floor). Light refreshments will be available during the poster sessions.
- ✧ Each poster will be assigned a number that corresponds to their location on the display board.
- ✧ Poster dimensions should not exceed 120 cm (height) and 85 cm (width), and should be in portrait orientation.
- ✧ The text should be readable from five feet away. Use a minimum font size of 20 points.
- ✧ We recommend you hang up your poster before 1625h Monday Jan 9. All posters should remain on display throughout the symposium.
- ✧ The poster presenter should be available for at least 1 hour during the poster sessions on both Monday and Tuesday.
- ✧ All posters should be removed by 1800h Wednesday, Jan 11.

Language

English is the official language of the symposium. PPT slides and posters should be in English. Oral talks should also be presented in English.

Sessions and Workshops

General Session 1: Physical oceanic processes: dynamics and physical-biological-biogeochemical interactions

Conveners:

Fei Chai, Second Institute of Oceanography, State Oceanic Administration, Hangzhou

Jianping Gan, Hong Kong University of Science and Technology

Leo Oey, Princeton University, USA

Zhiyu Liu, Xiamen University

Invited Speakers:

Ruoying He, North Carolina State University, USA

Robin Robertson, University of New South Wales, Australia

General Session 2: Marine & estuarine biogeochemistry

Conveners:

Wei-Jun Cai, University of Delaware, USA

Shuh-Ji Kao, Xiamen University

Cindy Lee, Stony Brook University, USA

Kitack Lee, Pohang University of Science and Technology, South Korea

James Murray, University of Washington, USA

Invited Speakers:

Anja Engel, GEOMAR Helmholtz-Center for Ocean Research Kiel, Germany

Tung-Yuan Ho, Academia Sinica, Taipei

General Session 3: Biological oceanography & global change

Conveners:

Hongbin Liu, Hong Kong University of Science and Technology

John Reinfelder, Rutgers University, USA

Dalin Shi, Xiamen University

Invited Speakers:

Donald Anderson, Woods Hole Oceanographic Institution, USA

Naomi Harada, Research and Development Center for Global Change, JAMSTEC, Japan

Alyse Larkin, University of California Irvine, USA

General Session 4: Marine environment, ecosystem & sustainability

Conveners:

Haizheng Hong, Xiamen University

Paul Lam, City University of Hong Kong

Xiaolin Li, Xiamen University

Anne E. McElroy, Stony Brook University, USA

Wen-Xiong Wang, Hong Kong University of Science and Technology

Invited Speakers:

Jay Gan, University of California, Riverside, USA

Anne E. McElroy, Stony Brook University, USA

Special Session 1: Ecosystem under multiple stressors

Conveners:

Sam DuPont, University of Gothenburg, Sweden

Kunshan Gao, Xiamen University

V. Thiagarajan, The University of Hong Kong

Invited Speakers:

Cristian A. Vargas, Universidad de Concepcion, Chile

Special Session 2: Changing ocean environment: from the sedimentary perspective -- processes and records

Conveners:

James T. Liu, National Sun Yat-Sen University, Kaohsiung

Adam D. Switzer, Nanyang Technological University, Singapore

Fengling Yu, Xiamen University

Invited Speakers:

Harry Jol, University of Wisconsin-Eau Claire, USA

Special Session 3: Size matters or not, particles export in marine environments

Conveners:

Ann Pearson, Harvard University, USA

Tiantian Tang, Xiamen University

Invited Speakers:

Hilary Close, University of Miami, USA

Alexander Laskin, Pacific Northwest National Laboratory, USA

Special Session 4: Biogeochemical cycling of trace elements in the ocean: GEOTRACES and beyond

Conveners:

Zhimian Cao, Xiamen University

Martin Frank, GEOMAR Helmholtz-Center for Ocean Research Kiel, Germany

Jing Zhang, University of Toyama, Japan

Special Session 5: Ocean-atmosphere interaction, multi-scale climate variability and their implication for biogeochemical processes

Conveners:

Mingfang Ting, Columbia University, USA

Xiaoyi Yang, Xiamen University

Invited Speakers:

John Church, CSIRO Marine And Atmospheric Research, Australia

Noel Keenlyside, University of Bergen, Norway

Bo Qiu, University of Hawaii, USA

Special Session 6: The ocean's energy cascade and mixing

Conveners:

Toshiyuki Hibiya, The University of Tokyo, Japan

Zhiyu Liu, Xiamen University

Invited Speakers:

William D Smyth, Oregon State University, USA

Special Session 7: Coastal assessments: From implementation to impact: understanding the gap

Conveners:

Yongming Luo, Yantai Institute of Coastal Zone Research, Chinese Academy of Sciences, Yantai

Alice Newton, University of the Algarve, Portugal

Martin Le Tissier, Future Earth Coasts

Special Session 8: Marine public education

Conveners:

Emily H. King, COSEE China, Xiamen University

Bayden Russell, The Swire Institute of Marine Science, School of Biological Sciences, The University of Hong Kong

Invited Speakers:

Bob Chen, University of Massachusetts Boston, USA

Tullio Rossi, Animate Your Science, Australia

Special Session 9: Microbial ecological processes and marine carbon cycle

Conveners:

Feng Chen, The University of Maryland, USA

Nianzhi Jiao, Xiamen University

Special Workshop: The use of assessments: Knowledge transfer and results interpretation

Conveners:

Yongming Luo, Yantai Institute of Coastal Zone Research, Chinese Academy of Sciences, Yantai

Alice Newton, University of the Algarve, Portugal

Shona Paterson, Future Earth Coasts

Martin Le Tissier, Future Earth Coasts

Satellite Workshop: Marine wildlife ecology and conservation

Conveners:

George Balazs, IUCN/SSC Marine Turtle Specialist Group, Oceania Region, Honolulu, Hawaii, USA

Min Liu, Xiamen University

Thierry Work, Honolulu Field Station, National Wildlife Health Center, Hawaii, USA

Program

Floor Plan

FIRST FLOOR

(NOT TO SCALE)

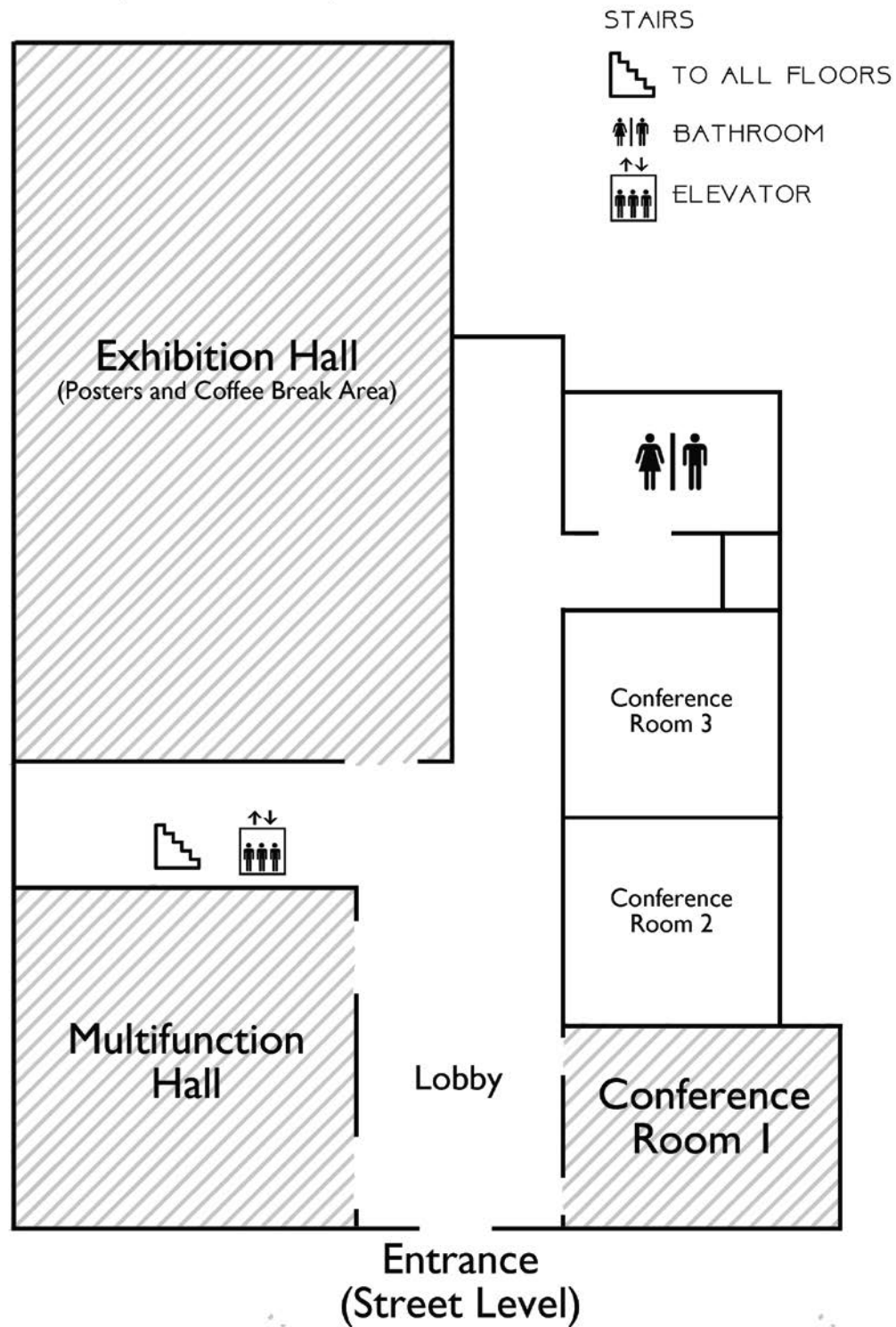

SECOND FLOOR

(NOT TO SCALE)

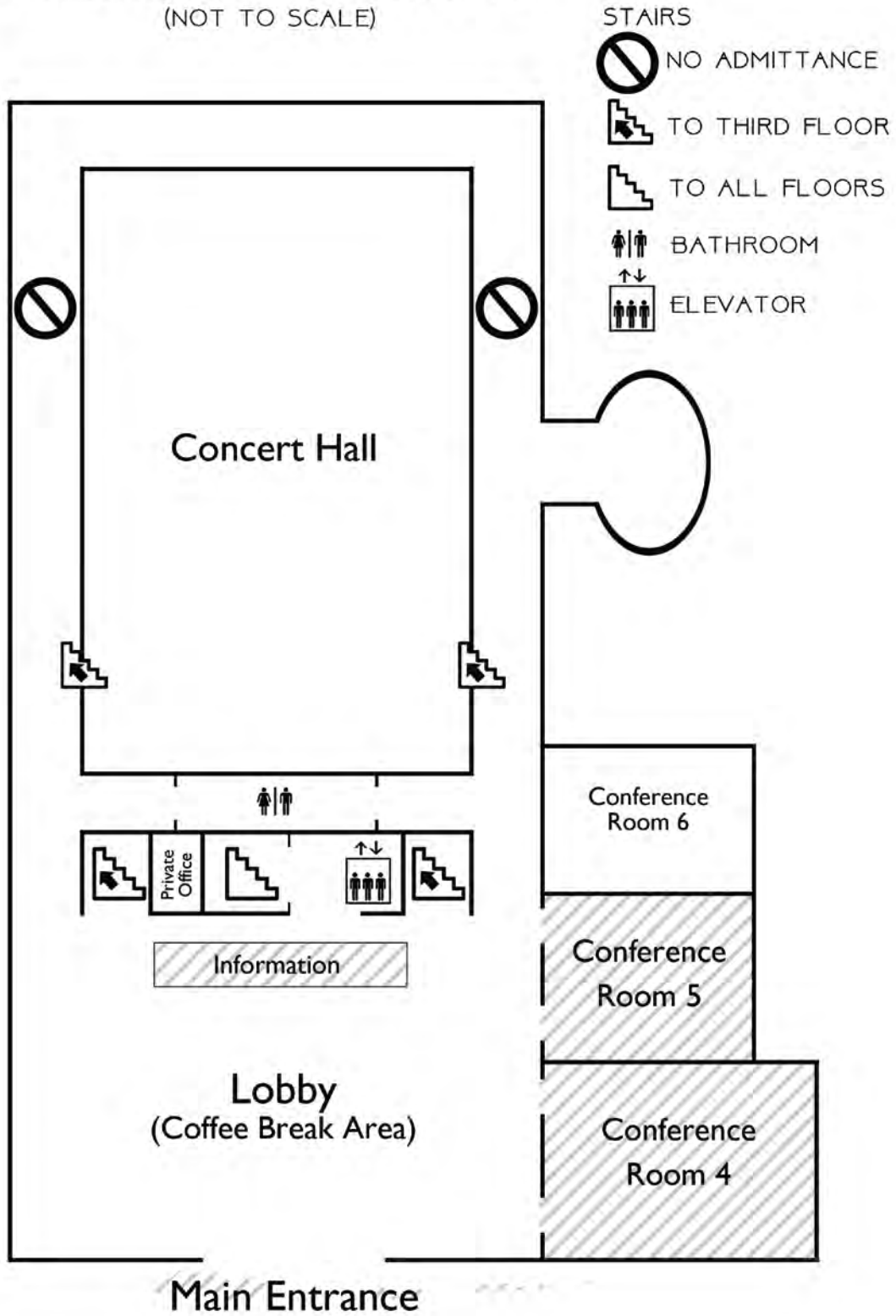

THIRD FLOOR

(NOT TO SCALE)

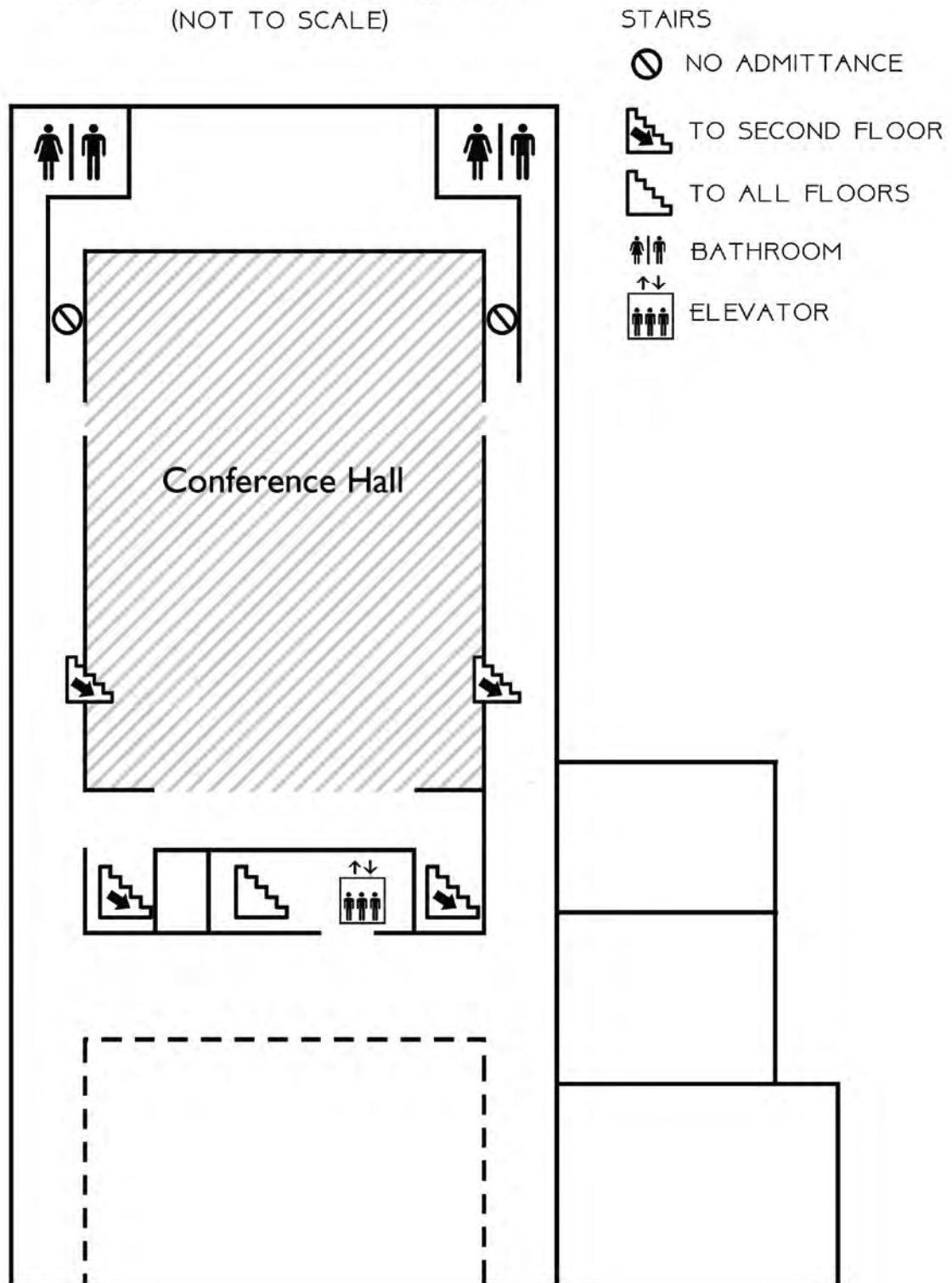

Program Layout

Sunday, Jan 8, 2017					
1600-2100	Registration (Luyuan Hall, Millennium Harborview Hotel, 2nd floor)				
1800-2100	Icebreaker (Luyuan Hall, Millennium Harborview Hotel, 2nd floor)				
Monday, Jan 9, 2017					
0820-0830	Opening (Conference Hall, 3rd floor)				
0830-0910	Keynote speech 1 Dennis McGillicuddy (Conference Hall, 3rd floor)				
0910-0950	Keynote speech 2 Mary Jane Perry (Conference Hall, 3rd floor)				
0950-1010	Break (Exhibition Hall, 1st floor & Lobby, 2nd floor)				
Time	Conference Hall (3rd floor)	Multi-function Hall (1st floor)	Room 1 (1st floor)	Room 4 (2nd floor)	Room 5 (2nd floor)
1010-1215	GS1	GS3	GS4	SS4	SS7
	Ruoying He	Donald Anderson	Jay Gan	Martin Frank	Alice Newton
	Fei Chai	Sven Kranz	Chung-shin Yuan	Hong Che	Yongming Luo
	Xiao Liu	Weida Gong	Yuefei Ruan	Rong Hu	Yi Xu
	Peng Xiu	Hii Kieng Soon	Mengyang Liu	Xin-Yuan Zheng	Jian Lu
	Shaoling Shang	Emilio Fernandez	Seung-Kyu Kim	Kai Jiang	Tu Chen
	Wenfang Lu	Yong Qiu	Kai Zhang	Mengli Chen	
	Lin Guo				
	Mingshun Jiang				
1215-1400	Lunch (Qinye Canteen)				
1255-1355	Open Discussion Session on Publication Practice in JGR-Oceans (Multi-function Hall, 1st floor)				
1400-1625	GS1	GS3	GS4	SS4	SS7
	Robin Robertson	Naomi Harada	Anne McElroy	Jing Zhang	Michael Elliott
	Huijie Xue	Yawei Luo	Ming Yang	Jingfeng Wu	Osamu Matsuda
	Jianping Gan	Yangyang Lu	Li Zhang	Deli Wang	Xiyong Hou
	James Liu	Saito Hiroaki	Qiaoguo Tan	Yihua Cai	Kevin Ho
	Leo Oey	Xingchen Wang	Po Teen Lim	Li Li	Hee Jun Lee
	Long Cao	Minhan Dai	Reece Wartenberg	Pinghe Cai	Yangfan Li
	Jia Wang	Zhongping Lee	Kazuhide Dan	Tianyu Chen	
	Jinfeng Ma				
	Hongyang Lin				
1625-1830	Poster Session I (Exhibition Hall, 1st floor)				
1830-2030	Student Night (Jian-Wen Building Cafe)				

Tuesday, Jan 10, 2017					
0830-0910	Keynote speech 3 Peter Brewer (Conference Hall, 3rd floor)				
0910-0920	Room change				
Time	Conference Hall (3rd floor)	Multi-function Hall (1st floor)	Room 1 (1st floor)	Room 4 (2nd floor)	Room 5 (2nd floor)
0920-1010	GS2	GS1	SS9	SS3	SS8
	Anja Engel	Dongxiao Wang	Nianzhi Jiao	Alexander Laskin	Ying Ye
	Louis Legendre	Hui Wu	Feng Chen	Hilary Close	Jing Wang
		Zhiqiang Liu			Angela Lehmann
1010-1030	Break (Exhibition Hall, 1st floor & Lobby, 2nd floor)				
1030-1230	GS2	GS1	SS9	SS3	SS8
	Weihong Zhao	Yuwu Jiang	Hongyue Dang	Ann Pearson	Bob Chen
	Yicheng Teng	Salvienty Makarim	Michael Gonsior	Lin Zhang	Jinghua Zhang
	Weidong Guo	John Z. Shi	Qiang Zheng	Jeomshik Hwang	Tsuyoshi Sasaki
	Xiujun Wang	Peng Cheng	Kai Tang	Shan Huang	Stanley Shea
	Xiaolin Li	Zhongya Cai	Nannan Wang	Hongyan Bao	Tullio Rossi
	Jianwu Tang	Hwa Chien		Tiantian Tang	Siting Zhuang
		Kyung Ryul Kim			Mo Chen
		Ruibin Ding			Chia-Dai Yen
1230-1400	Lunch (Qinye Canteen)				
1400-1625	GS2	GS3	SS5	SS6	
	Tung-Yuan Ho	Alyse Larkin	Noel Keenlyside	Bill Smyth	
	Zunli Lu	Tuo Shi	Mingfang Ting	Chuan Yu Liu	
	Chin-Chang Hung	Punyasloke Bhadury	Jinyi Yu	Toshiyuki Hibiya	
	Chuanjun Du	Sijun Huang	Xiao-Hai Yan	Robin Robertson	
	Guizhi Wang	Yanling Zheng	Qiang Deng	Ming-Huei Chang	
	Wen-Chen Chou	Tianjiao Dai	He Chao	Zhiliang Liu	
	Young Ho Ko	Yan Wang	Song Guo	Yuping Guan	
1625-1830	Poster Session II (Exhibition Hall, 1st floor)				
1700-1830	Women in Science Salon (Multifunction Hall, 1st floor)				
1830	Dinner (Rongyu Seafood Restaurant, buses leave at 1840)				

Wednesday, Jan 11, 2017					
0830-0910	Keynote speech 4 Richard Feely (Conference Hall, 3rd floor)				
0910-0920	Room change				
Time	Conference Hall (3rd floor)	Multi-function Hall (1st floor)	Room 1 (1st floor)	Room 4 (2nd floor)	Room 5 (2nd floor)
0920-1010	GS2	SS1	SS5	SS2	SPW
	Claudia Nelson	Sam Dupont	Bo Qiu	Harry Jol	Discussion
	James Murray	Cristian A. Vargas	W. Timothy Liu	Adam Switzer	
1010-1030	Break (Exhibition Hall, 1st floor & Lobby, 2nd floor)				
1030-1230	GS2	SS1	SS5	SS2	SPW
	Royston Uning	Mark Wells	Shuanglin Li	Zhongping Lai	Discussion
	Benoit Thibodeau	Yong Zhang	Wei Zhuang	Zhanghua Wang	
	Craig Tobias	Guang Gao	Weiwei Zhang	Daidu Fan	
	Zaixing Wu	Bayden Russell	Junlu Li	Selvaraj Kandasamy	
	Xuefeng Peng	Stefano Cannicci	Peigen Lin	Yu-Shih Lin	
	Jinyu Yang	V Rajan	Han Zhang	Dawei Li	
		Gray Williams		Weifang Chen	
				YijingWu	
1230-1400	Lunch (Qinye Canteen)				
1400-1605	GS2	SS6	SS5	SS2	SPW
	Lijun Hou	Haibin Song	John Church	Shouye Yang	Discussion
	Weilei Wang	Zhiyu Liu	Min Hu	Min Luo	
	Yonghui Gao	Suyun Noh	Yiran Peng	Harunur Rashid	
	Michio Aoyama	Chengzhu Xu	Bingbing Wang	Dongyan Liu	
	Xiuli Yan		Peng Lin	Yu Qian	
	Wentao Wang		Chenqi Hu	Rick Yang	
				Chuanxiu Luo	
				Luz Eva Fernández	
1605-1630	Break (Exhibition Hall, 1st floor & Lobby, 2nd floor)				
1630-1710	Keynote speech 5 Jonathan Zehr (Conference Hall, 3rd floor)				
1710-1800	Closing (Conference Hall, 3rd floor)				

Note: GS denotes General Session, SS denotes Special Session, SPW denotes Special Workshop.

Program

Sunday, January 8, 2017

Registration: 1600-2100

Icebreaker: 1800-2100

Luyuan Hall, Millennium Harborview Hotel (2nd floor)

Monday, January 9, 2017

Lobby of XMU Science and Art Center (2nd floor)			
0730-1830	On-site registration		
Conference Hall of XMU Science and Art Center (3rd floor)			
0820-0830	Minhan Dai	Xiamen University	Opening
	<u>Chair: Fei Chai</u>		
0830-0910	Dennis McGillicuddy	Woods Hole Oceanographic Institution	Keynote Speech: Mechanisms of physical-biological interaction at the oceanic mesoscale
	<u>Chair: Zhongping Lee</u>		
0910-0950	Mary Jane Perry	University of Maine	Keynote Speech: Assessing marine productivity from underwater autonomous platforms in Arctic and Subpolar oceans
0950-1010	Break(Exhibition Hall, 1st floor & Lobby, 2nd floor)		

General Session 1: Physical oceanic processes: dynamics and physical-biological-biogeochemical interactions Conveners: Fei Chai, Jianping Gan ,Leo Oey, Zhiyu Liu Conference Hall (3rd floor)			
	<u>Chair: Fei Chai and Jianping Gan</u>		
1010-1030	Ruoying He	North Carolina State University	Gulf Stream variability in the South Atlantic Bight and its impact on the regional marine biogeochemical processes

1030-1045	Fei Chai	Second Institute of Oceanography, State Oceanic Administration	Modeling nutrient and plankton dynamics of the San Francisco Bay
1045-1100	Xiao Liu	University of Southern California	Impact of fine-scale physical processes on marine ecosystem dynamics and carbon cycling in the North Pacific Subtropical Gyre
1100-1115	Peng Xiu	South China Sea Institute of Oceanology, Chinese Academy of Sciences	Future ecosystem change in a coastal upwelling system
1115-1130	Shaoling Shang	Xiamen University	A Phaeocystis bloom captured by an UAV
1130-1145	Wenfang Lu	Xiamen University & University of Delaware	Phytoplankton blooms associated with mesoscale activities: cases in the South China Sea
1145-1200	Lin Guo	South China Sea Institute of Oceanology, Chinese Academy of Sciences	The biological impacts of 2014-2015 warming on California Current System
1200-1215	Mingshun Jiang	Florida Atlantic University	Meso-scale dynamics and the impacts on variability of carbonate chemistry over deep coral reefs in the Florida Straits

General Session 3: Biological oceanography & global change**Conveners: Hongbin Liu, John Reinfelder, Dalin Shi****Multi-function Hall (1st floor)**

	<u>Chair: John Reinfelder and Dalin Shi</u>		
1010-1035	Donald Anderson	Woods Hole Oceanographic Institution	Weather and water mass anomalies provide insights into the response of cyst-forming HAB species to climate change scenarios
1035-1055	Sven Kranz	Florida State University	CO ₂ effects on the marine dinoflagellate <i>Karenia brevis</i> - carbon acquisition and photophysiology
1055-1115	Weida Gong	University of North Carolina at Chapel Hill	Molecular insights into a dinoflagellate bloom imply bacterial cultivation
1115-1135	Hii Kieng Soon	University of Malaya	Influences of inorganic nitrogen and phosphorous on the transcriptional levels of nutrient transporters and genes in a tropical Pacific strain of <i>Alexandrium minutum</i> (Dinophyceae)
1135-1155	Emilio Fernandez	University of Vigo	Co-limitation of coastal phytoplankton growth by inorganic nutrients and vitamins B1 or B12 varies seasonally off

			NW Spain
1155-1215	Yong Qiu	Xiamen University	The contribution of phytoplankton and zooplankton fecal pellets to carbon transport during a spring bloom in the East China Sea

General Session 4: Marine environment, ecosystem & sustainability**Conveners: Haizheng Hong, Paul Lam, Xiaolin Li, Anne E. McElroy, Wen-Xiong Wang****Meeting Room 1 (1st floor)**

	<u>Chair: Anne McElroy and Xiaolin Li</u>		
1010-1035	Jay Gan	University of California Riverside	Spatial and temporal trends of DDT and PCBs in marine sediment at a superfund site
1035-1055	Chung-shin Yuan	National Sun Yat-sen University	Field measurement of atmospheric speciated mercury at two subtropical islands in the Taiwan Strait and South China Sea
1055-1115	Yuefei Ruan	City University of Hong Kong	Stereoisomer-specific distribution of 1,2,5,6,9,10-hexabromocyclododecane and 1,2-dibromo-4-(1,2-dibromoethyl) cyclohexane in sediment and marine organisms from the South China Sea
1115-1135	Mengyang Liu	Xiamen University	Long range transport and fate of PAHs in seawater from the Western Pacific to the Southern Ocean (17.5°N - 69.2°S)
1135-1155	Seung-Kyu Kim	Incheon National University	Microplastics in Arctic environment: the preliminary result of 2016 ARAON expedition
1155-1215	Kai Zhang	City University of Hong Kong	Spatial and temporal distribution of microplastic pollution in tributary of the Three Gorges Reservoir—a case study in Xiangxi River

Special Session 4: Biogeochemical cycling of trace elements in the ocean: GEOTRACES and beyond Conveners: Zhimian Cao, Martin Frank, Jing Zhang Meeting Room 4 (2nd floor)			
	<u>Chair: Jing Zhang and Zhimian Cao</u>		
1010-1035	Martin Frank	GEOMAR Helmholtz Centre for Ocean Research Kiel	Evaluating ocean circulation and water mass mixing with radiogenic neodymium isotopes: potential and pitfalls
1035-1055	Hong Che	Ocean University of China	Contribution of East China Sea shelf water to the Sea of Japan and the Northwestern Pacific using neodymium isotope
1055-1115	Rong Hu	University of Cambridge	Coherent seawater neodymium isotopic evolution in the Southeast Atlantic and Southwest Pacific during glacial-interglacial cycles
1115-1135	Xin-Yuan Zheng	University of Wisconsin-Madison	Cycling of rare earth elements (REEs) in the South Atlantic
1135-1155	Kai Jiang	University of Toyama	First cold seep observation in the Brazilian margin with the human-occupied vehicle Shinkai 6500: Multiple geochemical investigation of the porewater and marine sediment
1155-1215	Mengli Chen	Earth Observatory of Singapore	Lead isotope exchange between dissolved and fluvial particulate matter: a laboratory study from the Johor River estuary

Special Session 7: Coastal assessments: From implementation to impact: understanding the gap Conveners: Yongming Luo, Alice Newton, Martin Le Tissier Meeting Room 5 (2nd floor)			
	<u>Chair: Yongming Luo and Alice Newton</u>		
1010-1035	Alice Newton	CIMA-University of Algarve	Future coasts and boundaries
1035-1055	Yongming Luo	Yantai Institute of Coastal Zone Research, Chinese Academy of Sciences	Coastal eco-environmental problems and coastal science development
1055-1115	Yi Xu	East China Normal University	IMBER-research for marine sustainability: synthesis and the way forward
1115-1135	Jian Lu	Yantai Institute of Coastal Zone Research, Chinese Academy of Sciences	Risk assessment of pesticides in the coastal aquatic environment

1135-1155	Tu Chen	Yantai Institute of Coastal Zone Research, Chinese Academy of Sciences	Coastal environmental damage assessment technology and ecological remediation strategy
-----------	---------	--	--

1215-1400**Lunch at Qinye Canteen**

1255-1355	Open Discussion Session on Publication Practice in JGR-Oceans Convened by Peter Brewer, Editor-in-chief, Journal of Geophysical Research-Oceans Assistant: Xiaolin Li, Xiamen University Multi-function Hall, 1st floor		
-----------	--	--	--

General Session 1: Physical oceanic processes: dynamics and physical-biological-biogeochemical interactions
Conveners: Fei Chai, Jianping Gan, Leo Oey, Zhiyu Liu
Conference Hall (3rd floor)

	<u>Chair: Leo Oey and Zhiyu Liu</u>		
1400-1420	Robin Robertson	University of New South Wales Canberra	Interactions on the Heard Island Plateau during HEOBI
1420-1435	Huijie Xue	South China Sea Institute of Oceanology, Chinese Academy of Sciences	Variability of the Pacific North Equatorial Current and its implications on Japanese eel (<i>Anguilla japonica</i>) larval migration
1435-1450	Jianping Gan	Hong Kong University of Science and Technology	Biogeochemical response to the rotating layered circulation in the China Seas
1450-1505	James Liu	National Sun Yat-sen University	The origin and fate of biogenic particles in summer trans-China Sea transport
1505-1520	Leo Oey	Princeton University	Biological productivity is related to changes of the Kuroshio
1520-1535	Long Cao	Zhejiang University	Simulated ocean carbon cycle response to climate change
1535-1550	Jia Wang	Xiamen University	Seasonal exchanges of the Kuroshio and shelf waters and their impacts on the shelf currents of the East China Sea
1550-1605	Jinfeng Ma	Institute of Atmospheric Physics, Chinese Academy of Sciences	Effects of the interannual variability in chlorophyll concentrations on sea surface temperatures in the east tropical Indian Ocean
1605-1620	Hongyang Lin	Xiamen University	A peculiar lens-shaped structure observed in the South China Sea

General Session 3: Biological oceanography & global change Conveners: Hongbin Liu, John Reinfelder, Dalin Shi Multi-function Hall (1st floor)			
	<u>Chair: Hongbin Liu and Dalin Shi</u>		
1400-1425	Naomi Harada	Research and Development Center For Global Change	Ocean acidification in the western Arctic Ocean and sub-arctic North Pacific -its impact on the marine calcifiers
1425-1445	Yawei Luo	Xiamen University	Decrease of <i>Trichodesmium</i> N ₂ fixation rate with ocean acidification projected by an optimal resource allocating cellular model
1445-1505	Yangyang Lu	Xiamen University	Light effects on N ₂ fixation and diazotroph derived nitrogen net release of <i>Trichodesmium</i> in Western Pacific and South China Sea
1505-1525	Saito Hiroaki	The University of Tokyo	Geography of biogenic elements in the North Pacific Ocean
1525-1545	Xingchen Wang	Princeton University	Natural forcing of the North Atlantic N cycle in the Anthropocene
1545-1605	Minhan Dai	Xiamen University	On the ocean acidification and hypoxia in the coastal seas
1605-1625	Zhongping Lee	University of Massachusetts Boston	Estimating basin-scale biological pump: Are we on the right track?

General Session 4: Marine environment, ecosystem & sustainability Conveners: Haizheng Hong, Paul Lam, Xiaolin Li, Anne E. McElroy, Wen-Xiong Wang Meeting Room 1 (1st floor)			
	<u>Chair: Paul Lam and Haizheng Hong</u>		
1400-1425	Anne McElroy	Stony Brook University	Factors affecting the health and fitness of Juvenile winter flounder: Associations between data from the cellular to population level
1425-1445	Ming Yang	Shanghai University	The toxic effects of bisphenol S showing immunomodulation in fish macrophage
1445-1505	Li Zhang	South China Sea Institute of Oceanology, Chinese Academy of Sciences	The mechanism of high arsenic bioaccumulation in marine fish
1505-1525	Qiaoguo Tan	Xiamen University	Modeling oyster metal bioaccumulation in a contaminated estuary: A Bayesian approach
1525-1545	Po Teen Lim	University of Malaya	Occurrence of toxic dinoflagellate <i>Alexandrium tamiyavanichii</i> along the coasts of South China Sea revealed by real-time quantitative PCR

1545-1605	Reece Wartenberg	City University of Hong Kong	The future of integrated multi-trophic aquaculture in the South China Sea, starting with the noble scallop, <i>Chlamys nobilis</i> (Reeve, 1852)
1605-1625	Kazuhide Dan	Akashi College	Model experiment on COD change with time when putting sugar in seawater to build a sustainable seawater purification system in quays

Special Session 4: Biogeochemical cycling of trace elements in the ocean: GEOTRACES and beyond

Conveners: Zhimian Cao, Martin Frank, Jing Zhang

Meeting Room 4 (2nd floor)

	<u>Chair: Martin Frank and Zhimian Cao</u>		
1400-1425	Jing Zhang	University of Toyama	What can we learn from rare earth elements and Nd isotope: material transport and interaction between the East China Sea and the western North Pacific
1425-1445	Jingfeng Wu	Shenzhen University & University of Miami	What controls dissolved iron distribution in the ocean?
1445-1505	Deli Wang	Xiamen University	Increased metals' fluxes from a typical medium-sized river under human perturbation
1505-1525	Yihua Cai	Xiamen University	An introduction of the upcoming Chinese Trace Elements and Isotopes Sampling System (C-TEISS)
1525-1545	Li Li	First Institute of Oceanography, State Oceanic Administration	Dissolved trace metal distributions and speciation in Yellow Sea, China
1545-1605	Pinghe Cai	Xiamen University	Large fluxes of dissolved iron from coastal sediments revealed by $^{224}\text{Ra}/^{228}\text{Th}$ disequilibrium
1605-1625	Tianyu Chen	University of Bristol	Deep ocean ventilation constrained by absolutely dated radiocarbon variability of deep-sea corals during the last deglaciation

Special Session 7: Coastal assessments: From implementation to impact: understanding the gap Conveners: Yongming Luo, Alice Newton, Martin Le Tissier Meeting Room 5 (2nd floor)			
	Chair: Osamu Matsuda and Michael Elliott		
1400-1425	Michael Elliott	The University of Hull	In search of the best cross-border and -sector marine assessment and governance model?
1425-1445	Osamu Matsuda	International Center for Environmental Management of Enclosed Coastal Seas	Integrated coastal management of Shima City, Japan and its assessment: A case study of the new Satoumi community
1445-1505	Xiyong Hou	Yantai Institute of Coastal Zone Research, Chinese Academy of Sciences	Analysis of variation and regional difference of extreme temperature events in coastal area of China during 1961-2014
1505-1525	Kevin KingYan Ho	The University of Hong Kong	Assessing the marine biodiversity and ecology of Tolo Harbour and Channel: towards an integrated framework for monitoring and managing marine ecological resources of Hong Kong
1525-1545	Hee Jun Lee	Korea Institute of Ocean Science and Technology	Suspended sand movements over surf-zone crescentic bars in an open-coast beach, Korea
1545-1605	Yangfan Li	Xiamen University	Assessing vulnerability and resilience of coupled urbanization and environmental system to inform coastal urban planning
1625-1830	Poster Session I (Exhibition Hall, 1st floor)		
1830-2030	Student Night (Jian-Wen Building Cafe)		

Tuesday, January 10, 2017

Lobby of XMU Science and Art Center (2nd floor)			
0730-1830	On-site registration		
Conference Hall of XMU Science and Art Center (3rd floor)			
	<u>Chair: George Wong</u>		
0830-0910	Peter Brewer	Monterey Bay Aquarium Research Institute	Keynote Speech: Depth deception: Re-writing deep ocean biogeochemical processes as functions of temperature, not depth
0910-0920	Room change		

General Session 1: Physical oceanic processes: dynamics and physical-biological-biogeochemical interactions			
Conveners: Fei Chai, Jianping Gan ,Leo Oey, Zhiyu Liu			
Multi-function Hall (1st floor)			
	<u>Chair: Jianping Gan and Leo Oey</u>		
0920-0935	Dongxiao Wang	South China Sea Institute of Oceanology, Chinese Academy of Sciences	The cross-isobaths flow and its dynamic implication on the continental currents in the Northern South China Sea
0935-0950	Hui Wu	East China Normal University	Origin and transport mechanism of Subei low-salinity water in the western Yellow Sea
0950-1005	Zhiqiang Liu	The Hong Kong University of Science and Technology	Resolving South China Sea circulation and dynamics from regional and global models
1005-1030	Break(Exhibition Hall, 1st floor & Lobby, 2nd floor)		
1030-1045	Yuwu Jiang	Xiamen University	The off-shore transport of the China Coastal Current over the Taiwan Bank in winter
1045-1100	Salvienty Makarim	Xiamen University	The Indonesian throughflow (ITF) and its impact on the Indian Ocean during the global warming slowdown period.
1100-1115	John Z. Shi	Shanghai Jiaotong University	Circulation within the Curved Channel of the north passage in the Changjiang River estuary: A vorticity approach

1115-1130	Peng Cheng	Xiamen University	On the residual velocity in sigma coordinates
1130-1145	Zhongya Cai	Hong Kong University of Science and Technology	Formation and dynamics of a long-lived eddy-train in the South China Sea
1145-1200	Hwa Chien	National Central University	Measurement and analysis of mixing processes in estuaries and coastal zone
1200-1215	Kyung Ryul Kim	Gwangju Institute of Science and Technology	Dissolved oxygen: A powerful tracer for changes in physical dynamics, a case for the East Sea (Japan Sea)
1215-1230	Ruibin Ding	Zhejiang University & Second Institute of Oceanography, State Oceanic Administration	Cross-shelf water exchange in the East China Sea as estimated by satellite altimetry and in situ hydrographic measurement

General Session 2: Marine & estuarine biogeochemistry**Conveners: Wei-Jun Cai, Shuh-Ji Kao, Cindy Lee, Kitack Lee, James Murray****Conference Hall (3rd floor)**

	<u>Chair: Shuh-Ji Kao</u>		
0920-0945	Anja Engel	Geomar Helmholtz Center for Ocean Research Kiel	Supply of organic matter to oxygen minimum zones in eastern boundary upwelling systems
0945-1010	Louis Legendre	University Paris VI	Transparent exopolymer particles (TEP) in the ocean: Sinking or not sinking, that is our question
1010-1030	Break(Exhibition Hall, 1st floor & Lobby, 2nd floor)		
1030-1050	Weihong Zhao	Institute of Oceanology, Chinese Academy of Sciences	The chromophoric organic matter in the surface sediment of Yellow China Sea
1050-1110	Yicheng Teng	National Central University	Global patterns of carbon-to-phosphorous ratios of marine organic matter export
1110-1130	Weidong Guo	Xiamen University	Assessing the sources and quality of estuarine particulate organic matter by spectral analysis
1130-1150	Xiujun Wang	Beijing Normal University	Pause in the decline of oxygen in the tropical Pacific Ocean's oxygen minimum
1150-1210	Xiaolin Li	Xiamen University	Sources and transformation of dissolved organic matter in the Pearl River Estuary
1210-1230	Jianwu Tang	Marine Biological Laboratory, Woods Hole	Greenhouse gas emissions in coastal salt marshes and the effect of restoration

Special Session 3: Size matters or not, particles export in marine environments Conveners: Ann Pearson, Tiantian Tang Meeting Room 4 (2nd floor)			
	<u>Chairs: Ann Pearson and Tiantian Tang</u>		
0920-0945	Alexander Laskin	Pacific Northwest National Laboratory	Atmospheric chemistry of marine aerosols
0945-1010	Hilary Close	University of Miami	Degradative status, microbial influence, and export potential of small size classes of particulate organic matter in open ocean water columns
1010-1030	Break(Exhibition Hall, 1st floor & Lobby, 2nd floor)		
1030-1050	Ann Pearson	Harvard University	Stable carbon isotope ratios of archaeal GDGTs in the marine water column and surface sediments
1050-1110	Lin Zhang	Texas A&M University Corpus Christi	Compound/position specific Nitrogen isotope analysis in amino acids and its application in paleoceanography
1110-1130	Jeomshik Hwang	Seoul National University	Characteristics of sinking particle export in the Amundsen Sea, Antarctica
1130-1150	Shan Huang	Jinan University	Latitude/season-dependent source contributions of marine boundary layer aerosols over the Atlantic Ocean
1150-1210	Hongyan Bao	Xiamen University	Molecular level characterization of water soluble organic carbon in the aerosols from China coastal seas to Northwestern Pacific Ocean
1210-1230	Tiantian Tang	Xiamen University	How to export pico-phytoplankton to the deep

Special Session 8: Marine public education Conveners: Emily H. King, Bayden Russell Meeting Room 5 (2nd floor)			
	<u>Chair: Emily King and Bayden Russell</u>		
0920-0935	Ying Ye	Zhejiang University	Outreach at Zhejiang University
0935-0950	Jing Wang	Conservation International	For a healthy ocean--conservation international's efforts on marine public education
0950-1005	Angela Lehmann	Xiamen University	The social life of the sea: How sociology can contribute to understanding and teaching about ocean life
1005-1030	Break(Exhibition Hall, 1st floor & Lobby, 2nd floor)		

1030-1045	Bob Chen	University of Massachusetts Boston	Novel strategies towards increasing public understanding of marine and climate science
1045-1100	Jinghua Zhang	Blue Ribbon Ocean Conservation Association	NGO's exploration and experience of marine public education in China
1100-1115	Tsuyoshi Sasaki	Tokyo University of Marine Science and Technology	Establishing a resilient and sustainable society by enhancement of food intrinsic value
1115-1130	Stanley Shea	BLOOM (HK)	In search of Hong Kong reef fishes: In the LOCAL waters and on your PLATE
1130-1145	Tullio Rossi	Animate Your Science	Paper accepted! Now what? Find your way to real impact using animation video.
1145-1200	Siting Zhuang	China Mangrove Conservation Network	Introduction to China Mangrove Conservation Network
1200-1215	Mo Chen	Guangxi Academy of Sciences	Marine education in Guangxi Province
1215-1230	Chia-Dai (Ray) Yen	National Taiwan Ocean University	Collaborate marine education resources through Asia Marine Educators Association (AMEA)

Special Session 9: Microbial ecological processes and marine carbon cycle**Conveners: Feng Chen, Nianzhi Jiao****Meeting Room 1 (1st floor)**

	<u>Chairs: Feng Chen and Nianzhi Jiao</u>		
0920-0945	Nianzhi Jiao	Xiamen University	The role of microbial processes in carbon sequestration, hypoxia and Ocean acidification
0945-1010	Feng Chen	University of Maryland	The microbial degradation of dissolved organic matter release from <i>Synechococcus</i> by viral-lysis in coastal seawater
1010-1030	Break(Exhibition Hall, 1st floor & Lobby, 2nd floor)		
1030-1050	Hongyue Dang	Xiamen University	Metabolization of biogenic climate-active gases mediated by marine microorganisms
1050-1110	Michael Gonsior	University of Maryland	Picocyanobacteria and deep-ocean fluorescent dissolved organic matter share similar optical properties
1110-1130	Qiang Zheng	Xiamen University	The shift of POC and DOC in <i>Synechococcus</i> culture and their associated heterotrophic bacterial community structure variation
1130-1150	Kai Tang	Xiamen University	Molecular insights to the interactions between dissolved organic matter and

			heterotrophic bacteria
1150-1210	Nannan Wang	Xiamen University	Integrative modeling of microbial diversity-productivity relationships based on Tara Oceans

1230-1400**Lunch at Qinye Canteen****General Session 2: Marine & estuarine biogeochemistry****Conveners: Wei-Jun Cai, Shuh-Ji Kao, Cindy Lee, Kitack Lee, James Murray****Conference Hall (3rd floor)**

	<u>Chair: Wei-Jun Cai</u>		
1400-1425	Tung-Yuan Ho	Academia Sinica	The fluxes and fates of aerosol trace metals in the northern South China Sea and the Western Philippine Sea
1425-1445	Zunli Lu	Syracuse University	Ocean oxygenation under past greenhouse and icehouse conditions: perspectives from iodine proxy
1445-1505	Chin-Chang Hung	National Sun Yat-sen University	Using rare earth elements to constrain particulate organic carbon flux in the East China Sea
1505-1525	Chuanjun Du	Xiamen University	Vertical nitrogen, phosphorus and carbon fluxes in an oligotrophic oceanic regime: the South China Sea
1525-1545	Guizhi Wang	Xiamen University	Fluxes of dissolved carbon and nutrients via submarine groundwater discharge into subtropical Sansha Bay, China
1545-1605	Wen-Chen Chou	National Taiwan Ocean University	CO ₂ dynamics in the Dongsha Atoll, northern South China Sea
1605-1625	Young Ho Ko	Pohang University of Science and Technology	Direct determination of organic carbon export from N starving surface oceans

General Session 3: Biological oceanography & global change**Conveners: Hongbin Liu, John Reinfelder, Dalin Shi****Multi-function Hall (1st floor)**

	<u>Chair: John Reinfelder and Hongbin Liu</u>		
1400-1425	Alyse Larkin	University of California Irvine	Microdiverse populations shape <i>Prochlorococcus</i> niche space and predicted response to future ocean warming
1425-1445	Tuo Shi	Xiamen University	High throughput pyrosequencing unravels hidden diversity of algal symbionts in scleractinian corals along China's

			southeast coast
1445-1505	Punyasloke Bhadury	Indian Institute of Science Education and Research Kolkata	Exploring the diversity of marine planktonic cyanobacterial assemblages in a coastal biotope- integration of uncultured and cultured approaches
1505-1525	Sijun Huang	South China Sea Institute of Oceanology, Chinese Academy of Sciences	Viruses follow the footprints of hosts in the ocean: a case study on the biogeographies of marine cyanophages and cyanobacteria
1525-1545	Yanling Zheng	East China Normal University	Shifts in the community structure and activity of anaerobic ammonium oxidation bacteria along an estuarine salinity gradient
1545-1605	Tianjiao Dai	Peking University	Metagenomics reveals microbial community dynamics under natural and anthropogenic impact in the sediment of Hangzhou Bay, China
1605-1625	Yan Wang	Hainan University	Gene flow, genetic structure, and adaptability differentiation of stony coral <i>Galaxea fascicularis</i> around Hainan Island

Special Session 5: Ocean-atmosphere interaction, multi-scale climate variability and their implication for biogeochemical processes
Conveners: Mingfang Ting, Xiaoyi Yang
Meeting Room 1 (1st floor)

	<u>Chair: Xiao-Yi Yang</u>		
1400-1425	Noel Keenlyside	University of Bergen	Tropical Atlantic variability and predictability - PREFACE project
1425-1445	Mingfang Ting	Columbia University	Tropical Atlantic SST decadal variability: the role of tropical Pacific versus Subpolar Atlantic
1445-1505	Jinyi Yu	University of California	The increased influence of Atlantic Ocean on Pacific climate after early-1990s
1505-1525	Xiao-Hai Yan	University of Delaware	An overview of the global warming hiatus: Slowdown or redistribution?
1525-1545	Qiang Deng	Xiamen University	A stochastic multcloud parameterization scheme for the GCM
1545-1605	He Chao	Institute of Tropical and Marine Meteorology, China Meteorological Administration	Responses of the summertime subtropical anticyclones to global warming
1605-1625	Song Guo	Peking University	Characteristics and origins of organic aerosols in the coastal atmosphere of East China

Special Session 6: The ocean's energy cascade and mixing Conveners: Toshiyuki Hibiya, Zhiyu Liu Meeting Room 4 (2nd floor)			
	Chair: Zhiyu Liu and Toshiyuki Hibiya		
1400-1425	Bill Smyth	Oregon State University	Pulsating stratified turbulence in the upper equatorial oceans
1425-1445	Chuanyu Liu	Institute of Oceanology, Chinese Academy of Sciences	Effects of Tropical Instability Waves (TIWs) in inducing thermocline mixing in the eastern Equatorial Pacific
1445-1505	Toshiyuki Hibiya	The University of Tokyo	The impacts of ocean bottom roughness and tidal flow amplitude on abyssal mixing
1505-1525	Robin Robertson	University of New South Wales Canberra	The latitude dependence of internal tides, internal waves, and mixing
1525-1545	Ming-Huei Chang	National Taiwan University	Trains of large kelvin–helmholtz billows observed in the Kuroshio above a seamount
1545-1605	Zhiliang Liu	Institute of Oceanology, Chinese Academy of Sciences	Geographical distribution and anisotropy of the oceanic inverse kinetic energy cascade
1605-1625	Yuping Guan	South China Sea Institute of Oceanology, Chinese Academy of Sciences	Multiple modes of ocean striations
1625-1830	Poster Session II (Exhibition Hall, 1st floor)		
1700-1830	Women in Science Salon (Multi-function Hall, 1st floor)		

1830-2130**Conference Dinner at Rongru Seafood Restaurant****(Buses leave at 1840)**

Wednesday, January 11, 2017

Conference Hall of XMU Science and Art Center (3rd floor)			
	<u>Chair: James Murray</u>		
0830-0910	Richard Feely	NOAA Pacific Marine Environmental Laboratory	Keynote Speech: Ocean acidification: An emerging global problem for marine ecosystems
0910-0920	Room change		

General Session 2: Marine & estuarine biogeochemistry			
Conveners: Wei-Jun Cai, Shuh-Ji Kao, Cindy Lee, Kitack Lee, James Murray			
Conference Hall (3rd floor)			
	<u>Chair: Cindy Lee</u>		
0920-0945	Claudia Benitez-Nelson	University of South Carolina	Neurotoxins and the environment. understanding the production, cycling and fate of domoic acid along the California Coast.
0945-1010	James Murray	University of Washington	Nitrogen fixation in the Black Sea
1010-1030	Break(Exhibition Hall, 1st floor & Lobby, 2nd floor)		
1030-1050	Royston Uning	National University of Malaysia	Detection of volatile organic compounds emissions from sea surface microlayer using thermal desorption sorbent tubes
1050-1110	Benoit Thibodeau	University of Hong Kong	Evidence of dissolved organic nitrogen assimilation in arctic coastal ecosystem
1110-1130	Craig Tobias	University of Connecticut	Nitrogen reduction pathways in estuarine sediments: Influences of organic carbon and sulfide
1130-1150	Zaixing Wu	Institute of Oceanology, Chinese Academy of Sciences	Seasonal variations of ammonium uptake and regeneration rates in the Changjiang (Yangtze) River estuary
1150-1210	Xuefeng Peng	University of California, Santa Barbara	Nitrification and nitrate assimilation in the subarctic North Atlantic
1210-1230	Jinyu Yang	Pohang University of Science and Technology	Decadal changes of excess nitrate in the upper North Atlantic Ocean

Special Session 1: Ecosystem under multiple stressors Conveners: Sam DuPont, Kunshan Gao, V. Thiyagarajan Multi-function Hall (1st floor)			
	<u>Chair: V Rajan</u>		
0920-0945	Sam Dupont	University of Gothenburg	Ocean acidification: The theoretical revolution
0945-1010	Cristian A. Vargas	Universidad de Concepcion	Species-specific response to ocean acidification is a consequence of local adaptation and adaptive plasticity
1010-1030	Break(Exhibition Hall, 1st floor & Lobby, 2nd floor)		
	<u>Chair: Sam DuPont</u>		
1030-1047	Mark Wells	University of Maine	Ocean acidification and iron availability: a natural multiple stressor experiment in iron limited upwelling waters
1047-1104	Yong Zhang	Xiamen University	Specific effects of low nitrate, low phosphate and ocean acidification on physiological responses of <i>Emiliania huxleyi</i> to a variety of light intensities
1104-1121	Guang Gao	Marine Resources Development Institute of Jiangsu	Combined effects of elevated pCO_2 and temperature on biomass and carbon fixation of phytoplankton assemblages in the northern South China Sea
1121-1138	Bayden Russell	The University of Hong Kong	Losing ecosystem resistance to change: when grazers fail to compensate for primary productivity
1138-1155	Stefano Cannicci	The University of Hong Kong	Does heavy metal exposure decrease thermal tolerance of crabs? A case study from the subtropical mangroves of Hong Kong
1155-1212	V Rajan	The University of Hong Kong	Biofouling in high- CO_2 coastal oceans: importance of multiple stressors interactions
1212-1229	Gray Williams	The University of Hong Kong	High and dry: which species are most vulnerable to heat stress on tropical shores?

Special Session 2: Changing ocean environment: from the sedimentary perspective -- processes and records Conveners: James T. Liu, Adam D. Switzer, Fengling Yu Meeting Room 4 (2nd floor)			
	<u>Chair: James Liu</u>		
0920-0950	Harry Jol	University of Wisconsin-Eau Claire	Subsurface imaging of the coastal landscape: mapping environmental change
0950-1010	Adam Switzer	Nanyang Technological University	Investigating the main driving factors in the Holocene evolution of Qing'ao Embayment, Nan'ao Island, southern China
1010-1030	Break(Exhibition Hall, 1st floor & Lobby, 2nd floor)		
1030-1045	Zhongping Lai	China University of Geosciences	Coupled evolution of river, delta and sea level change under glacial-interglacial cycles
1045-1100	Zhanghua Wang	East China Normal University	The Holocene evolution of Yangtze River (Changjiang) mouth, China: Stratigraphy, morphologic evolution and sediment budget
1100-1115	Daidu Fan	Tongji University	Clay-mineral compositions of sediments in the Gaoping River-Sea system: implications for weathering, sedimentary routing and carbon cycling
1115-1130	Selvaraj Kandasamy	Xiamen University	Perspectives on the terrestrial organic matter transport and burial along the land-deep sea continuum
1130-1145	Yu-Shih Lin	National Sun Yat-Sen University	Biogeochemical processes and material exchange in the silty intertidal sediment of an open-coast tidal flat (Chongming Eastern Flat, China)
1145-1200	Dawei Li	Xiamen University	Decoupled organic carbon burial and productivity in the subtropical north Pacific
1200-1215	Weifang Chen	Xiamen University	Sediment accumulation rates and carbon burial in the northern South China Sea
1215-1230	YijingWu	Tongji University	The use of redox sensitive elements in revealing sedimentary history of spreading hypoxia off the Changjiang Estuary: applicability and possible limitations

Special Session 5: Ocean-atmosphere interaction, multi-scale climate variability and their implication for biogeochemical processes Conveners: Mingfang Ting, Xiaoyi Yang Meeting Room 1 (1st floor)			
	<u>Chair: Mingfang Ting</u>		
0920-0945	Bo Qiu	University of Hawaii	Decadal variability, impact, and prediction of the Kuroshio Extension system
0945-1010	W. Timothy Liu	Jet Propulsion Laboratory	Linking temporal-spatial variations of carbon dioxide fugacity and acidity estimated from satellite observations
1010-1030	Break(Exhibition Hall, 1st floor & Lobby, 2nd floor)		
1030-1050	Shuanglin Li	Institute of Atmospheric Physics and Climate Change Research Center, Chinese Academy of Sciences	The coordinated effect of Arctic sea ice reduction and ENSO on Eurasian winter climate
1050-1110	Wei Zhuang	Xiamen University	Effect of excessive equatorial cold tongue bias on the El Niño simulations in CMIP5 models
1110-1130	Weiwei Zhang	Xiamen University	The Atlantic Subpolar Gyre ocean heat content variability and its decompositions
1130-1150	Junlu Li	Hong Kong University of Science and Technology	Variability of the current system in the tropical western Pacific Ocean: Numerical modeling study
1150-1210	Peigen Lin	Xiamen University	Characteristics of upwelling in the Alaskan Beaufort Sea based on 6 years of mooring data
1210-1230	Han Zhang	Xiamen University	Upper ocean response to Typhoon Kalmaegi (2014) and its implication on ocean heat transport

1230-1400**Lunch at Qinye Canteen**

General Session 2: Marine & estuarine biogeochemistry**Conveners: Wei-Jun Cai, Shuh-Ji Kao, Cindy Lee, Kitack Lee, James Murray****Conference Hall (3rd floor)**

	<u>Chair: James Murray</u>		
1400-1420	Lijun Hou	East China Normal University	Dissimilatory nitrate reduction processes and associated contribution to nitrogen removal in the Yangtze Estuary
1420-1440	Weilei Wang	University of California Irvine	Nitrate limitation as the primary driving force of dinitrogen fixation.
1440-1500	Yonghui Gao	Shanghai Jiaotong University	Assessing net ecosystem production in the Chesapeake Bay from underway O ₂ /Ar data
1500-1520	Michio Aoyama	Fukushima University	Global RM-scaled nutrients dataset and its application to studies of global physical/biogeochemical changes in the ocean
1520-1540	Xiuli Yan	Xiamen University	Spatial distribution and isotopic characteristics of dissolved and particulate organic nitrogen in Changjiang plume
1540-1600	Wentao Wang	Institute of Oceanology, Chinese Academy of Sciences	The nitrification rate and nitrate dynamics in the Changjiang River estuary and its adjacent waters

Special Session 2: Changing ocean environment: from the sedimentary perspective -- processes and records**Conveners: James T. Liu, Adam D. Switzer, Fengling Yu****Meeting Room 4 (2nd floor)**

	<u>Chair: Harry Jol</u>		
1400-1420	Shouye Yang	Tongji University	Intrusion of Kuroshio Current into the East China Sea shelf and Okinawa Trough since the LGM
1420-1435	Min Luo	Shanghai Ocean University	More reducing bottom-water redox conditions during the Last Glacial Maximum in the southern Challenger Deep (Mariana Trench, western Pacific) driven by enhanced productivity
1435-1450	Harunur Rashid	Shanghai Ocean University & Memorial University of Newfoundland	Deep-sea records of abrupt past monsoon changes: why it matters to understand the mechanisms?
1450-1505	Dongyan Liu	East China Normal University	Palaeoecological analysis of phytoplankton regime shifts in response to coastal eutrophication
1505-1520	Yu Qian	Nanjing University	Physical and sedimentary processes on the tidal flat of central Jiangsu Coast,

			China: headland induced tidal eddies and benthic fluid mud layers
1520-1535	Rick Yang	National Sun Yat-sen University	Land-sea duel in the late quaternary at the river mouth on a high standing island
1535-1550	Chuanxiu Luo	South China Sea Institute of Oceanology, Chinese Academy of Sciences	Modern pollen study in northern Kalimantan Island and its application in paleoclimate reconstruction in the southern South China Sea since 40 ka BP
1550-1605	Luz Eva Fernández	University of Vigo	Mercury footprint of the anthropocene in the sedimentary record of Galicia Continental Shelf

Special Session 5: Ocean-atmosphere interaction, multi-scale climate variability and their implication for biogeochemical processes

Conveners: Mingfang Ting, Xiaoyi Yang

Meeting Room 1 (1st floor)

	<u>Chair: Mingfang Ting</u>		
1400-1425	John Church	CSIRO Marine and Atmospheric Research	Understanding sea level change
1425-1445	Min Hu	Peking University	Evolution of secondary aerosols during transport at coastal receptor site of the YRD
1445-1505	Yiran Peng	Tsinghua University	Investigation on transportation and deposition of Asian Dust and its effect on marine biological activity in the Northwest Pacific Ocean
1505-1525	Bingbing Wang	Xiamen University	Chemical imaging of individual marine influenced atmospheric particles collected over South China Sea
1525-1545	Peng Lin	Pacific Northwest National Laboratory	Molecular chemistry of brown carbon aerosol
1545-1605	Chenqi Hu	Tsinghua University	A mesoscale convective system feature database based on satellite infrared images

Special Session 6: The ocean's energy cascade and mixing

Conveners: Toshiyuki Hibiya, Zhiyu Liu

Multi-function Hall (1st floor)

	<u>Chair: Toshiyuki Hibiya and Zhiyu Liu</u>		
1400-1420	Haibin Song	Tongji University	Study of internal waves and internal solitary waves shoaling by observations and numerical simulations
1420-1440	Zhiyu Liu	Xiamen University	Pathway from tides to turbulence: fission of internal solitary waves over shoaling topography

1440-1500	Suyun Noh	Seoul National University	Observations on internal wave modulations under varying mesoscale conditions in the southwestern East/Japan Sea
1500-1520	Chengzhu Xu	University of Waterloo	Numerical simulations of shoaling internal solitary waves of elevation

1605-1630**Break (Exhibition Hall, 1st floor & Lobby, 2nd floor)**

Conference Hall of XMU Science and Art Center (3rd floor)			
	<u>Chair: Nianzhi Jiao</u>		
1630-1710	Jonathan Zehr	University of California, Santa Cruz	Keynote Speech: Marine microbes, ocean biogeochemistry and environmental change: From genes to ecosystems
	<u>Chair: Wenju Cai</u>		
1710-1730	Best Student Poster Award Committee: Wenju Cai (Chair), Cindy Lee, Ya-Wei Luo, Bayden Russell, Emilio Fernández Suárez, Gray Williams		
1730-1750	Minhan Dai / Dalin Shi	Xiamen University	Closing

Special Workshop: The use of assessments: Knowledge transfer and results interpretation	
Conveners: Yongming Luo, Alice Newton, Shona Paterson, Martin Le Tissier	
Meeting Room 5 (2nd floor)	
0920-1605	<u>Chair: Yongming Luo, Alice Newton, Shona Paterson</u>

Sunday, January 8, 2017

Venue: Meeting Room 5

Satellite Workshop: Marine wildlife ecology and conservation Conveners: George Balazs, Min Liu, Thierry Work Meeting Room 5 (2nd floor)	
	<u>Chair : George Balazs, Thierry Work, Min Liu</u>
0830-0900	Registration, open ceremony
	<u>Chair: Min Liu</u>
0900-0930	Fall and rise of the Hawaiian green turtle: a 50-year witness to cultural and conservation change (George Balazs)
0930-1000	Argos and satellite tracking of sea turtles: pathways to bring people together for conservation (Denise M. Parker)
1000-1030	Marine wildlife health and disease (Thierry Work)
1030-1100	Coffee break
	<u>Chair: George Balazs</u>
1100-1120	Chinese white dolphins in Chinese waters – Status and Challenges (Wenhua Liu)
1120-1140	Population structure of <i>S. chinensis</i> in Xiamen water (Xianyan Wang)
1140-1200	Recent years the satellite tracking tests of China Sea Turtle Bay (Zhongrong Xia)
1200-1330	Lunch
	<u>Chair: Curator Fenwu Lin</u>
1330-1430	Travel to Xiamen Underwater World in Gulangyu
1430-1500	Underwater World Tour
	<u>Chair: Thierry Work</u>
1500-1800	Practice on health examination and blood sampling on turtles

Poster List

Poster Session Time Slots:1625-1830 on Jan 9 and Jan 10

Venue: Exhibition Hall (1st floor)

No.	Presenter	Poster Title
GS1-01	Caiyun Zhang	Long-term changes of Zhe-Min coastal water in the Taiwan Strait during winter and spring
GS1-02	Bin Chen	Seasonal variation characteristics of hydrological environment factors and suspended sediment transport mechanisms in Luanhe Estuary, China
GS1-03-S	Xiao Chen	Interannual and inter-decadal variability of the North Equatorial Countercurrent in the Western Pacific
GS1-04-S	Yi-Ting Cheng	Mixed-layer current and cyclonic eddies induced by tropical cyclones
GS1-05-S	Danxi Chen	Hydrodynamics and sediment transport in response to sequential reclamations over Tianjin port subtidal waters
GS1-06-S	Dezhi Chen	Aeolian sand movement law in coastal frontier
GS1-07	Shan Gao	Resurfacing of South Pacific Tropical Water in the equatorial Pacific and its variability associated with ENSO
GS1-08	Yining Chen	Links between physical environments and wetland vegetation changes: A biomorphodynamic study
GS1-10	Lanli Guo	Impacts of climate changes on ocean surface gravity waves over the eastern Canadian shelf
GS1-11-S	Lu Han	Inter-basin heat and salt transports by eddies from the Agulhas Leakage
GS1-12	Rex Chiwing Hui	Circulation physics in vorticity equations
GS1-13-S	Jianshan Mao	Modeling asymmetric-tidal-mixing-induced residual flow in a periodically stratified estuary
GS1-14	Wenming Lin	Satellite scatterometer-derived sea surface wind vectors and wind variability
GS1-15-S	Yuan Li	Study on the relationship between the sediment resuspension and advection under the influence of tidal current in the Changjiang Estuary.
GS1-17	Lei Ren	Comparative study on surface flow fields using High Frequency CODAR observation and numerical modelling
GS1-18-S	Xinyou Lin	A new method to investigate driving mechanisms of residual flow
GS1-19-S	Tingfei Lan	The evolution of the Yangtze River Delta since Holocene and numerical simulation.
GS1-21	Junmin Li	Modeling oceanic dynamics for islands and reefs in the South China Sea
GS1-22	Xiaomei Liao	Potential new production in two upwelling regions of the western Arabian Sea: Estimation and comparison
GS1-23-S	Jiaxing Liu	Nitrogen fixation within an anticyclonic eddy in the northeastern South China Sea
GS1-24-S	Runqing Lv	River plume responds to downwelling-favorable wind

No.	Presenter	Poster Title
GS1-26-S	Nabir Mamnun	Storm surge modelling in the Bay of Bengal: A review
GS1-28	Peng Qi	Subsurface oceanography in southern East China Sea: Spatiotemporal characteristics of temperature and salinity on isopycnal surfaces
GS1-29-S	Pgrni Pussella	Coastline changes in Sri Lanka
GS1-31-S	Zhehai Shang	Shadow error in water-leaving radiance measurements estimated from Monte-Carlo simulations
GS1-33	Lina Song	Semi-annually alternating exchange of intermediate waters east of the Philippines
GS1-34-S	Jieping Tang	The research on the relationship between the SSC and tides, waves near the seabed
GS1-36	Qinsheng Wei	Mechanisms leading to the frequent occurrences of hypoxia off the Changjiang estuary in summer
GS1-37-S	Wenbin Yin	Evolution of submesoscale coastal frontal waves in the East China Sea based on geostationary ocean color imager observational data
GS1-39	Jiexin Xu	The impacts of internal waves on concentrations of nutrients and chlorophyll on Monterey Bay, California
GS1-40-S	Yang Yang	On the variability of near-bed floc size due to complex interactions between turbulence, SSC, settling velocity, effective density and the fractal dimension of flocs
GS1-42	Mingxian Guo	Seasonal variability of sea surface chlorophyll distribution for mesoscale eddies in the South China Sea
GS1-43-S	Jie Huang	Sea surface chlorophyll responses to cyclonic eddies in subtropical southeastern Pacific Ocean
GS1-44-S	Dan Huo	The seasonal distribution characteristics and analysis of ocean surface mixed layer in the northern South China Sea
GS1-45-S	Shengyao Sun	The Kuroshio intrusion into the South China Sea revealed by radium isotopes
GS1-46-S	Chenmin Yu	Process and dynamic linkage of the circulation along the northern South China Sea shelf
GS1-47-S	Xinna Wu	A combined interpolation method for oceanographic data based on objective analysis and shepard model
GS2-01-S	Zhirong Zhang	Dynamics of sea surface $p\text{CO}_2$ on the inner-shelf of the East China Sea based on buoy time series observations
GS2-02	Bin Wang	Summer subsurface oxygen minimum in Min-Zhe coastal upwelling zone
GS2-03	Dan Yu	Storm-driven pulse input of riverine nutrients and potential effects on coastal ecosystems
GS2-04-S	Lianbao Chi	The monthly variations of dissolved oxygen distribution off the Changjiang River Estuary and its adjacent waters
GS2-05-S	Peng Huang	Ventilation time and anthropogenic CO_2 in the South China Sea based on CFCs and SF6 measurements
GS2-06-S	Disong Yang	Radium in the lower reaches of the Yellow River: Concentrations and fluxes under the influence of the Water-Sediment Regulation

No.	Presenter	Poster Title
		Scheme
GS2-07-S	Xin Fan	Research of surface sediment biogenic elements distribution in the Yangtze River Estuary and adjacent waters
GS2-08-S	Shuchai Gan	Pretreatments and data interpretation of dissolved organic matter (DOM) characterized by Excitation Emission Matrix Spectroscopy (EEMs) in subseafloor pore water
GS2-09	Hui Peng	Unbiased identification of natural halogenated compounds and their functional proteins
GS2-10-S	Shuai Gu	Impacts of nutrients limitation and microbial community structure on biodegradation of extraneous dissolved organic matter from Kuroshio intrusion in the northern South China Sea
GS2-11-S	Faisal Hamzah	Dynamics of the carbonate system in the Western Indonesian Seas during Southeast Monsoon
GS2-12	Ting-Chang Hsu	Comparison nitrous oxide production between water column and sediments in the early stage of hypoxia in the inner shelf off Changjiang Estuary
GS2-13	Wei-Jen Huang	Wind-induced variations of water surface carbon dioxide across the middle Chesapeake Bay
GS2-14-S	Xin Jiang	Variations of picoplankton abundances during early spring bloom in the Taiwan Bank: A case study
GS2-15	Xueyan Jiang	Redox sensitive trace elements (U, Cr, V) and their response to the redox conditions of the pore water in the Changjiang Estuary and adjacent shelf of East China Sea
GS2-16-S	Lim Joon Hai	Biogeochemistry of coastal water in the west and east coast of Peninsular Malaysia
GS2-17	Cindy Lee	Effects of higher CO ₂ and temperature on gel particle composition and physical properties of diatom aggregates: Results from mesocosm and aggregation experiments.
GS2-18-S	Lei Li	Re-evaluation of the biogeochemistry of dissolved inorganic arsenic in the Baltic Sea: Impact of anthropogenic activity
GS2-19-S	Chenglong Li	Revisiting seasonal variations of carbonate system and aragonite saturation state in the North Yellow Sea: Driving factors and future predictions
GS2-20-S	Huanxin Li	The contribution of opal-associated phosphorus to bioavailable phosphorus in surface and core sediments in the East China Sea
GS2-21-S	Junjie Li	Abundance, sinking and resuspension of particulate phosphorus in Daya Bay, Northern South China Sea
GS2-22	Li Yan	The homogeneity study of the sea surface temperature data along the coast of the China Seas
GS2-23	Hua Lin	Effects of El Nino 2016 on nitrous oxide in the Changjiang (Yangtze River) Estuary during summer
GS2-24-S	Li'an Lin	Rhizospheric bacterial communities of <i>Spartina alterniflora</i> in Leizhou Peninsula of China
GS2-25	Zhiwei Lin	Continuous water sampling cavity ring-down spectroscopy

No.	Presenter	Poster Title
		(CWS-CRDS) for real-time measurements of water isotopes
GS2-26-S	Nan Ling	Dynamics of dissolved organic matter in a subtropical tidal mangrove creek under multiple anthropogenic pressures
GS2-27-S	Li Liu	Ammonia and nitrite oxidation in the northern South China Sea
GS2-28-S	Qian Liu	Role of suspended particulate matter in regulating the behavior of dissolved uranium in the Yellow River Estuary
GS2-29-S	Xiaotong Liu	Study on the geochemical character of carbon and nitrogen and sedimentary environment evolution of radial tidal sand ridges system in the South Yellow Sea, China
GS2-30-S	Yuan Liu	Trace elements (As, Hg, V, Sb) and stable isotope ratios ($\delta^{13}\text{C}$ and $\delta^{15}\text{N}$) in aquatic organisms from Yellow River Estuary and Laizhou Bay, North China
GS2-31	Zhongming Lu	Hypoxia formed by eutrophication and bottom convergence to the west off the Pearl River Estuary
GS2-32-S	Wei Yang	Diagnosing controls of inter-seasonal changes of surface sea water $p\text{CO}_2$ in the northern South China Sea basin
GS2-33	Jian Ma	Trends in the determination of phosphorus in seawater
GS2-34	Xiangli Wang	The chromium isotopic composition of the ocean
GS2-35-S	Manping Zhang	Molecular and stable isotopic evidence for the occurrence of nitrite-dependent anaerobic methane-oxidizing bacteria in mangrove sediment of Zhangjiang Estuary, China
GS2-36	Qian Liu	Seasonal and inter-annual changes of land input into the inner Toyama Bay, central Japan
GS2-37-S	Elliott Roberts	Anthropogenic CO_2 in the northern South China Sea Basin
GS2-38-S	Shangguan Qipei	Precise spectrophotometric measurement of seawater pH and carbonate ion concentrations with an automated apparatus
GS2-39	Guisheng Song	Absorbance photobleaching of chromophoric dissolved organic matter in the Yangtze River Estuary
GS2-40	Ni Su	Effect of typhoon-induced Sr isotope dynamics in a subtropical river system, southeast China
GS2-42-S	Ehui Tan	Sedimentary denitrification exceeds anammox is the dominated nitrogen removal pathway in the Jiulong River Estuary
GS2-43-S	Fenfang Wang	Lateral nutrient exchange between mangrove and estuary
GS2-44	Kui Wang	Real-time monitoring of nutrients in the Changjiang Estuary reveals short-term nutrient-algal bloom dynamics
GS2-45-S	Dujun Wei	Spatiotemporal variability of physical-biological process in Hong Kong waters: Observational study
GS2-46	Yanhua Wu	Nitrogen dynamics in a eutrophic coastal bay off southern China: implications for N_2O production
GS2-47-S	Yuling Wu	Distribution of particulate organic carbon and elemental carbon in the Jiulong River-Estuary and their correlations with persistent organic pollutants
GS2-48	Xiaomin Xia	<i>Synechococcus</i> assemblages across the salinity gradient in a salt wedge estuary

No.	Presenter	Poster Title
GS2-49-S	Xin Wang	Isotopic constraint on the sources and biogeochemical cycling of nitrate in the Jiulong River Estuary
GS2-50	Dapeng Xu	Protistan diversity and activity in the South China Sea revealed by high throughput sequencing
GS2-51	Kui Xu	The mechanism and physiological role of excitation transfer among PSII units in four marine phytoplankters
GS2-52	Li Xu	Multiple sources and dynamic cycling of ocean dissolved organic carbon revealed by carbon isotopes
GS2-53	Hong Yang	Carbon transport from Yellow River to sea affected by reservoir regulation
GS2-54	Guoyu Yin	Effects of multiple antibiotics exposure on denitrification process in the Yangtze Estuary sediments
GS2-55-S	Chia-Lin Yu	Diurnal variations of carbonate system in the Pearl River estuary and adjacent shelf during summer
GS2-56-S	Dan Yu	Nitrogen dynamic and transformation across the Jiulong River-estuary Interface in Southeast China
GS2-57-S	Mingzhen Yu	Heavy metals from Kueishantao shallow-sea hydrothermal vents, offshore northeast Taiwan
GS2-58	Hui He	Community composition and distribution of sulfate- and sulfite-reducing prokaryotes in sediments from the Changjiang Estuary and its adjacent area in the East China Sea
GS2-59	Yongquan Yuan	Major transport fluxes of nutrients in the continental shelf waters of East China Sea
GS2-60-S	Yuan Yuan	Underway analysis of nanomolar dissolved reactive phosphorus in oligotrophic seawater with automated hybrid on-line solid phase extraction and spectrophotometric system
GS2-61	Weidong Zhai	Exploring biogeochemical generations of DIC/DIN in the North Branch of inner Changjiang Estuary: Controls and environmental effects in dry seasons
GS2-62-S	Yan Zhang	The effect of biomass variations of <i>Spartina alterniflora</i> on the organic carbon content and composition of a salt marsh in northern Jiangsu Province, China
GS2-64-S	Liwen Zheng	The status and characteristics of eutrophication in the Bohai Sea
GS2-65-S	Peng Zhou	Intrusion pattern of Kuroshio subsurface water onto the East China Sea continental shelf by dissolved inorganic iodine species and other tracers in spring and autumn
GS2-66-S	Tianyu Zhou	Distribution and biogeochemical cycles of silicon in the Yangtze Estuary and its adjacent area
GS2-67	Xudong Zhu	Temporal variability of canopy light use efficiency and its environmental controls in a subtropical mangrove wetland
GS2-68	Weijun Cai	Estuarine acidification in the Chesapeake Bay
GS2-69-S	Shunyan Cheung	Diazotrophs in West Philippine Sea under influence of mesoscale eddies
GS2-70-S	Yingxu Wu	What drives the latitudinal gradient in open ocean surface DIC?

No.	Presenter	Poster Title
GS2-71-S	Chao Wang	Hydrological and biogeochemical controls on absorption and fluorescence of dissolved organic matter in the northern South China Sea
GS2-72-S	Jiapeng Wu	Controls on aammox and dnitrification in Pearl River Estuary sediment
GS2-73-S	Hui Lin	Size characteristics of chromophoric dissolved organic matter in the Chukchi Sea
GS2-74-S	Yan Wang	A method for microbial ammonia oxidation rate and nitrite oxidation rate analysis without depending on inhibitors
GS2-75-S	Min Xu	Enhancing and diminishing effects of light on uptake and oxidation of regenerated nitrogen
GS2-76-S	Qingquan Hong	Solute transport into the Jiulong River estuary via pore water exchange and submarine groundwater discharge: New insights from $^{224}\text{Ra}/^{228}\text{Th}$ disequilibrium
GS3-01-S	Majda Aouititen	Study of strandings of the jellyfish <i>Pelagia noctiluca</i> in the Mediterranean coastline of tetouan (NW of Morocco)
GS3-02	Bangqin Huang	Contribution of phytoplankton and zooplankton fecal pellets to particulate organic carbon flux in continental China Seas
GS3-03-S	Siwei Chang	Dissecting the impact of $p\text{CO}_2$ and pH on <i>Trichodesmium</i> IMS 101
GS3-04-S	Chu Chen	Influence of zooplankton grazing on the global marine nitrogen fixation by using structure equation model
GS3-05	Jixin Chen	Seasonal variations of phytoplankton as a response to environmental changes in the surface waters of salinity front along the Jiulong River Estuary
GS3-06	Hongyue Dang	Comparison of putative diazotrophic microbial communities in sediments among three environmentally-distinct marginal seas of the western Pacific Ocean
GS3-07-S	Yuelel Dong	Different ways to regulate non-photochemical fluorescence quenching under excess intensity in marine diatom <i>Thalassiosira pseudonana</i>
GS3-08-S	Yang Feng	The infection of demethylation of genomic DNA to the <i>Symbiodinium Kawagutii</i>
GS3-09-S	Kanagarajan Umapathi	Distribution and phylogenetic diversity of cbbM genes encoding rubisco form ii in surface sediments of the western pacific ocean
GS3-10-S	Lulu Fu	Distribution of anaerobic ammonia oxidation bacteria in sediments from the adjacent seas of Yangtze Estuary
GS3-11-S	Jian Gao	Nutritional analysis of <i>Aureococcus anophagefferens</i>
GS3-13-S	Shannon Hanson	Investigating nitrogen cycling within the coral holobiont using stable isotope and metagenomic analysis
GS3-14-S	Zhengjie Hou	Elemental composition of diatoms: Implications for Redfield or non-Redfield uptake?
GS3-15	Anyi Hu	Spatial and temporal dynamics of microbial communities in a human-perturbed estuary of China
GS3-16-S	Yibin Huang	Net community production in the South China Sea from in situ

No.	Presenter	Poster Title
		O ₂ measurements on a profiling Bio-Argo
GS3-17	Hongmei Jing	Seasonal shift of AOA communities and activities in the Pearl River Estuary
GS3-18-S	Kangkai Li	The effect of climate change on the abundance and structure of Nitrogen-fixing bacterial communities associated with corals
GS3-20-S	Ying Ke	Dynamics of carbon metabolism of free-living and attached bacteria at two contrasting subtropical coastal sites
GS3-21-S	Lingfen Kong	Marine metaproteomics: Comparative evaluation of protein extraction protocols
GS3-22-S	Po-Chien Kuan	Impact of typhoon Soulik on primary production in the South China Sea
GS3-23	Kuowei Lan	Association between the interannual variation in the oceanic environment and catch rates of bigeye tuna (<i>Thunnus obesus</i>) in the Atlantic Ocean
GS3-24-S	Danyang Li	Nitrogen fixation in a subtropical bay in south China which strongly affect by human activities
GS3-25-S	Xueqian Lei	Comprehensive insights into antagonistic impacts on diatom by a bacterium with direct algicidal activity
GS3-26-S	Hongfei Li	The preliminary exploration about competitive advantage between three <i>Symbiodiniums</i> under different conditions.
GS3-27-S	Meizhen Li	Phosphorus deficiency inhibits cell division but not growth in the <i>dinoflagellate</i> <i>Amphidinium carterae</i>
GS3-28	Meng Li	Niche specialization of the nitrogen transforming functional genes in mangrove and intertidal mudflats revealed by metagenomic analysis
GS3-29-S	Tangcheng Li	Identification, characterization and phosphate depleted-inducible expression of PhoA _{ty} -type alkaline phosphatase of <i>Emiliania huxleyi</i>
GS3-30-S	Weiyang Li	The biological roles of cadmium in the coccolithophore <i>Emiliania huxleyi</i> CCMP 1516
GS3-31	Yu Li	Innovative conceptual models for quantitative analysis of viral shunt in nutrient cycling
GS3-32-S	Lingxiao Lin	Diversity and evolution of an ultraviolet sunscreen pathway in aquatic environment
GS3-33	Xin Lin	Differences of strain-specific metabolomics responses to heat stress between symbiotic <i>Symbiodinium kawagutii</i> (Clade F) and free-living <i>Symbiodinium</i> sp. (Clade E)
GS3-34-S	Linggang Zheng	Engineering cyanobacteria to generate higher production of ethanol
GS3-35	Hongbin Liu	Elemental stoichiometry and nutrient regeneration of <i>Noctiluca scintillans</i> in response to prey of different nutrient quality
GS3-36-S	Tianqi Liu	CO ₂ exhaustion induces the expression of C ₄ cycle of a marine dinoflagellate <i>Prorocentrum donghaiense</i>
GS3-37	Xin Liu	Group-specific growth and grazing rates for phytoplankton in the South China Sea basin
GS3-39-S	Hao Luo	ATP utilization by <i>Karenia mikimotoi</i> using multifaceted molecular

No.	Presenter	Poster Title
		machinery
GS3-40	Linlin Zhang	Organisms' response to environment: Insights from functional and evolutionary genomics
GS3-41	Ping Sun	An integrative approach to phylogeny reveals patterns of environmental distribution and novel evolutionary relationships in a major group of ciliates
GS3-42-S	Ling Qiao	Quantitative PCR analysis of the spatiotemporal dynamics of <i>Aureococcus anophagefferens</i> and <i>Minutocellus polymorphus</i> and the relationship between brown tides and nutrients in the coastal waters of Qinhuangdao
GS3-43	John R. Reinfelder	CO ₂ regulation of nutrient resource competitiveness in marine diatoms
GS3-44	Zuoxi Ruan	The availability of energy influences the impact of the use of different N chemical sources on energy partitioning among metabolic processes, in the cyanobacterium <i>Synechococcus</i> sp
GS3-45	Mitsuhide Sato	Effects of temperature on size composition of pico- and nanophytoplankton in the subtropical water: Possible contribution of mixotrophs
GS3-46	Huaxia Sheng	N ₂ fixation and it's transportation in coral holobiont
GS3-48	Senjie Lin	Transcriptomic and micro RNAomic profiling reveals multi-faceted mechanisms of coping with phosphate stress in a dinoflagellate
GS3-49-S	Xi Su	Separate effects of pCO ₂ and pH on the diatoms <i>Phaeodactylum tricornutum</i> and <i>Thalassiosira pseudonana</i>
GS3-50-S	Danye Sun	Exploring <i>Symbiodinium</i> diversity and host specificity in coral communities from southeast coast of China with 454 amplicon pyrosequencing
GS3-51-S	Huihui Sun	The response of phytoplankton community to the water-sediment regulation event in the adjacent sea of the Yellow River Estuary
GS3-52	Swee Keong Yeap	Optimised sample quality for amplicon metagenomic sequencing
GS3-53-S	Shangjin Tan	Blocking PCR amplification of metazoan DNA for characterization of microbial eukaryotic diversity
GS3-54-S	Xianhui Wan	Biologically-associated Nitrous Oxide (N ₂ O) accumulation in sunlit ocean
GS3-55-S	Jierui Wang	Rhodopsin's genes diversity for some dinoflagellates
GS3-56-S	Weimin Wang	Effects of Asian dust input on eukaryotic phytoplankton community structure in the open areas in Northwestern Pacific Ocean
GS3-57-S	Zuozhu Wen	N ₂ fixation in two coastal upwelling regions of the Taiwan Strait
GS3-58-S	Yiyong Wong	Vibrio community in the coastal waters of Peninsular Malaysia
GS3-59	Xiaotian Han	Responses of <i>Phaeodactylum tricornutum</i> to environmental factors variations by fourier transform spectroscopy
GS3-60-S	Xie Le	Modeling effect of temperature on the interaction between marine viroplankton and bacteria
GS3-61	Yuyuan Xie	Habitat controls on phytoplankton community structure and primary productivity in the northern South China Sea

No.	Presenter	Poster Title
GS3-62-S	Yan Jiang	Measurement of 5-aminolevulinic acid in laboratory and field samples
GS3-63-S	Youting Ye	Effects of ocean acidification on the response of <i>Trichodesmium</i> to phosphorus starvation
GS3-64	Weiwei You	Potential impacts of global warming and temperature adaptation on shellfish aquaculture: The case from abalone
GS3-65	Yuan Dong	Size-dependent of phytoplankton growth and microzooplankton grazing in the northern South China Sea during summer, 2015
GS3-66-S	Yuanyuan Li	Microbial diversity and nitrogen utilization strategy in different regimes of the Western Pacific Ocean
GS3-67-S	Yudong Cui	Enhancement of non-photochemical quenching as an adaptive strategy under phosphorus deprivation in the dinoflagellate <i>Karlodinium veneticum</i>
GS3-68-S	Xiangxi Zeng	Plankton respiration in the northern South China Sea during summer and winter
GS3-69-S	Futing Zhang	Effects of ocean acidification on <i>Trichodesmium</i> IMS101 under phosphorus limited condition
GS3-70	Hao Zhang	Metaproteomics reveals metabolic activities between the blooming and non-blooming samples of phytoplankton collected at the coastal East China Sea
GS3-71-S	Jingjing Zhang	A highly sensitive method for analyzing marker phytoplankton pigments: Ultra-high-performance liquid chromatography-tandem triple quadrupole mass spectrometry
GS3-72-S	Kaidian Zhang	Explored genetic transformation of dinoflagellate using various transformation techniques
GS3-73-S	Zhenzhen Zheng	Inverse temperature effect on rate measure for nitrifier community in the South China Sea
GS3-74-S	Qun Li	<i>Ostreopsis</i> (Dinophyceae) in China Seas: Biodiversity, distribution and toxin production
GS3-75	Chuanmin Hu	A satellite-based system to observe algal blooms and water quality in near real-time
GS3-76-S	M.Naveen	Decadal variations of phytoplankton biomass using modis ocean colour data- bay of bengal waters, India
GS3-77	liping Zheng	Effect of eutrophication on phytoplankton growth and microzooplankton grazing in the estuarine and coastal waters of Sanya, South China Sea.
GS4-01	Balaji Prasath. B.	Control of harmful cyanobacterium <i>Microcystis aeruginosa</i> using nanoparticles
GS4-02	Min Zhang	Hand portable capillary electrophoresis instrument for distributed monitoring heavy metals in environmental water
GS4-03	Andry Herizo Rasolomaharavo	Assessment of the state of vitality of a marine ecosystem facing the investment project: the case of mining, port infrastructure in Toamasina (Eastern Madagascar)
GS4-04	Kapuli Gani	Heterogeneity and contribution of free-living nematodes in

No.	Presenter	Poster Title
	Mohamed Ansari	geographically distant mangrove ecosystems
GS4-05	Kapuli Gani Mohamed Ansari	Elucidating heterogeneity of free-living nematode communities in geographically distant mangrove ecosystems in link with prevailing environmental gradients
GS4-06-S	Mian Chen	Fate and transfer flux of polycyclic aromatic hydrocarbons in seawater from the North Pacific to the Arctic: Insights from field measurements and multimedia model simulation
GS4-07-S	Ranju Chowdhury	Phytoremediation of trace metals from rhizosediment by native mangrove plants of Indian Sundarban Wetland
GS4-08-S	Dominic Brettell	Spawning is right in the appropriate light: Lunar periodicity of reproductive behaviour amongst marine invertebrates
GS4-09-S	Chengrong Guo	An In-situ colorimetric optical imaging sensor with diffusive gradient in thin-film for determination of dissolved Fe(II) in pore and bottom waters
GS4-10-S	junli Guo	The distribution, sources and ecological risk assessment of surface sediments in the south coastal mud area off Zhejiang and Fujian
GS4-11	Shujin Guo	Abundance, sinking rates and carbon export of transparent exopolymer particles in the Changjiang (Yangtze River) Estuary, China
GS4-12-S	Buce Hetharua	Mangrove microbial community succession, interaction and functional properties under contamination of petroleum diesel fuel
GS4-13-S	Lingming Huang	Developmental toxicity of the organophosphate flame retardant tris(1,3-dichloro-2-propyl) phosphate (TDCPP) in marine medaka
GS4-14-S	Xizhi Huang	Hemocyte responses of the thick shell mussel <i>Mytilus coruscus</i> exposed to nano-TiO ₂ and seawater acidification
GS4-15-S	Sanober Kahkashan	Perfluorinated compounds in surface sediment from the northern Bering Sea, Chukchi Sea and adjacent Arctic areas
GS4-16-S	Ing Kuo Law	Diversity of the harmful microalgae in relation to nutrients variability in Sungai Geting, Tumpat, east coast of Peninsular Malaysia
GS4-17	Chui Pin Leaw	Spatial and temporal heterogeneity of benthic harmful dinoflagellate community assemblages at the fringing reefs of Malaysia: Implications of coral reef health
GS4-18-S	Li Keat Lee	Benthic dinoflagellate assemblages associated with Ciguatera Fish Poisoning (CFP) at fringing coral reef ecosystem of Perhentian Islands
GS4-19-S	Dongxu Li	Community structure and metabolic activities of bacterioplankton during the blooming period of <i>Prorocentrum donghaiense</i> in the coastal East China Sea
GS4-20-S	Winnie Lik Sing Lau	Flow cytometry analysis of toxic <i>Alexandrium minutum</i> bloom at east cost of Peninsular Malaysia
GS4-21	Kunde Lin	Measurement of freely dissolved DDT and metabolites in seawater using solid-phase microextraction with performance reference compounds
GS4-22	Quanlong Li	Sampler based on osmotic pump and solid phase extraction for

No.	Presenter	Poster Title
		time-integrated sampling of of pollutants in water
GS4-23-S	Yan Lin	Reconstruction of evolving anthropogenic activities and climate change from pahs and pb deposition in the northern south china sea: more evidence from Pb isotopic composition and positive matrix factorization
GS4-24-S	Guat Ru Liow	Encystment-excystment of a tropical toxic dinoflagellate, <i>Alexandrium minutum</i> (Dinophyceae)
GS4-25-S	Soumita Mitra	Distribution of metals in dissolved and particulate phase in human impacted Hooghly River Estuary, India
GS4-26-S	Priyanka Mondal	Contamination of trace elements and its ecological risk assessment in sediments along the Ganges River Estuary, India
GS4-27	Lin Qi	Long-term trend of <i>Ulva prolifera</i> blooms in the western Yellow Sea
GS4-28	Yaowen Qiu	Accumulation and partitioning of POPs and trace metals in nine mangrove species and sediments from three estuarine wetlands of Hainan island, south China
GS4-29-S	Dibyendu Rakshit	Anthropogenic stresses on plankton ecology in Indian <i>Sundarban</i> megadelta: An approach towards ecosystem conservation and sustainability
GS4-30-S	João Marcelo Silva	Mangroves, heavy metals and the food chain: Do crabs choose between contaminated and non-contaminated leaves?
GS4-31	Yuxin Sun	Halogenated organic pollutants in mangrove wetlands of the Pearl River Estuary, South China
GS4-32-S	Suh Nih Tan	Distribution of the diatom <i>Nitzschia navis-varinginca</i> (Bacillariophyceae), a domoic acid producer from Malaysian waters
GS4-33-S	Shengyuan Teng	Modelling essential fish potential habitat for <i>Acanthopagrus schlegelii</i> in the coastal waters off Western Taiwan for the spawning season.
GS4-34	Vahab Vaezzadeh	Distribution and source identification of polycyclic aromatic hydrocarbons (PAHs) in sediments of mangrove swamps in the west coast of Peninsular Malaysia
GS4-35-S	Shu Wang	A simple method for the determination of glyphosate and aminomethylphosphonic acid in seawater matrix with high performance liquid chromatography and fluorescence detection
GS4-36	Hanhong Luo	Construction and application of Marine Monitoring and Information Services Platform (MIS) in Xiamen Bay and its adjacent sea area
GS4-37	Xinhong Wang	Developmental toxicity and embryotoxicity of sulfamethazine in marine medaka (<i>Oryzias melastigma</i>) embryos
GS4-38-S	Zilan Wu	Air-sea exchange and gas/particle partitioning of polycyclic aromatic hydrocarbons from the East China Sea to the Northwest Pacific: Assessment of influence of East Asian continental outflow
GS4-39-S	Xiaolan Lin	Time-series phylogenetic molecular ecological networks reveal cooperation of microbial communities in response to BaP contamination
GS4-40-S	Miaolei Ya	Anthropogenic organochloride compounds as potential tracers of

No.	Presenter	Poster Title
		regional water masses: A case study of estuarine plume, coastal eddy, wind-driven upwelling and long-range warm current
GS4-41-S	Lye Ying Ling	Sulfonamide residues and resistance genes in Taiping river estuary, Perak
GS4-42	Yu Mo	Alkaline phosphatase activity and phytoplankton phosphorus stress in the continental marginal sea with large river plume
GS4-43-S	chenchen zhang	Distribution and ecological risk assessment of PAHs in surface sediments from the Yangze Estuary and the old Yellow River Estuary
GS4-44-S	Shufeng Zhang	Transcriptomic analysis reveals novel molecular mechanisms involved in phosphorus acclimation in a marine dinoflagellate <i>Prorocentrum donghaiense</i>
GS4-45-S	Xiaomei Zhen	The spatial distribution and sources of halogenated flame retardants (HFRs) in Xiaoqing River
GS4-46	Zhilu Fu	Point-of-no-return in ephyrae of the moon jellyfish <i>Aurelia aurita</i> s.l.
GS4-47	Jiezhong Wu	Response of land-sea interface in Xiamen Bay to extreme weather events observed with the ecological dynamic buoy array, a multifunctional sensors system
SS1-02-S	Kanmani Chandra Rajan	Will ocean acidification affect molluscan shell?
SS1-03-S	Lei Cui	Relationship between phytoplankton community succession and environmental parameters in Qinhuangdao coastal areas, China
SS1-05	Kunshan Gao	Marine primary producers under influence of ocean acidification
SS1-07	Xuguang Huang	Urea can enhance Ni bioavailability and alleviate Ni toxicity in <i>Procentrum donghaiense</i> (Dinophyta)
SS1-08	Gang Li	Interactive effects of photoperiod and light on diatom growth and photoinactivation of photosystem II
SS1-09	Wei Li	Effects of seawater acidification on the growth rates of the diatom <i>Thalassiosira (Conticribra) weissflogii</i> under different nutrient, light, and UV radiation regimes
SS1-10	Xin Lin	Noncoding and coding transcriptome responses of a marine diatom to ocean acidification
SS1-11-S	Minglei Ma	Function analysis of rhodopsin in dinoflagellate
SS1-12-S	Wing Kwan Mak	Effect of UV radiation and phosphate supply on <i>Trichodesmium</i>
SS1-13-S	Michele Mei	The effect of ocean acidification on metamorphosis-related signaling pathways in bivalve mollusks
SS1-17	Youji Wang	Seawater acidification increases physiological toxicity of nano-TiO ₂ in the mussel <i>Mytilus coruscus</i>
SS1-19	Juntian Xu	CO ₂ rise shortens life cycle span of a green tide alga
SS1-20	Zhiguang Xu	NH ₄ ⁺ enrichment and UV radiation interact to affect the photosynthesis and nitrogen uptake of <i>Gracilaria lemaneiformis</i> (Rhodophyta)
SS2-01-S	Meng Chen	Reservoir-induced changes to fluvial fluxes and their downstream impacts on sedimentary processes: The Changjiang (Yangtze) River, China

No.	Presenter	Poster Title
SS2-03-S	Zhiyun Du	Variations in quantity, composition and grain size of Changjiang sediment discharging into the sea in response to human activities
SS2-04-S	Fang Liu	The n-alkane records from a sediment core in the lower slope of the northeastern South China Sea over the last 17 ka: implications for climate and vegetation variation
SS2-05	Jianhua Gao	Changjiang catchment changes induced by human activities and its impact on the sedimentary system of estuary- coast-shelf area
SS2-06-S	Haohao Lu	The influence of wind farm on the marine sedimentary environment
SS2-07	Xing Jian	Triassic sedimentary-tectonic evolution of the Eastern Paleo-Tethys ocean and surrounding lands: Constraints from a provenance study of the Songpan-Ganzi turbidites
SS2-08-S	Hui Sheng	Distribution of ^{210}Pb in the sediment of subaqueous Changjiang (Yangtze) Delta and its implications for the sediment dynamics
SS2-09-S	Qidong Shi	A numerical investigation of freshwater and sediment discharge variations of Poyang Lake catchment, China over the last 1000years
SS2-10-S	Zih-Hang Tang	A case study of sedimentary n-alkanes collecting from a small river without flow passing through mountain belt of Taiwan
SS2-11	Aijun Wang	Trapping effect of estuarine turbidity maximum on particulate organic carbon and its response to a typhoon event in a macro-tidal estuary
SS2-12-S	Duorong Wang	Environmental changes in Shamei Lagoon, Hainan Island, China Interactions between natural processes and human activities.
SS2-13-S	Lin Wang	Biogeochemical characteristics of suspended particles in the inner continental shelf of the East China Sea
SS2-15-S	Can Yang	Provenance and lithogenic controls on the preservation of organic matter in recent sediments from the continental shelf of the East China Sea
SS2-16-S	Weiming Jiang	Paleoenvironmental evolution since 45ka BP based on sedimentary pollen records of 121712 core in the Northeastern Indian Ocean
SS3-01-S	Haoyang Ma	^{210}Po and ^{210}Pb in the northern South China Sea: Implications for export and resuspension of particulate matter
SS3-02	Hongliang Li	Intensified seasonal variation of mesopelagic biogenic flux associated with mesoscale eddy in the Central South China Sea
SS3-03	Jingjing Zhang	Response of sinking biogenic fluxes to monsoon, eddy and dust events in the Northwestern South China Sea
SS3-04-S	Yi-Fong Wu	Size distribution of sinking particles in different marine environments
SS3-05	Zhengchao Wu	Spatial distributions of polyunsaturated aldehydes and their biogeochemical implications in the Pearl River Estuary and the adjacent northern South China Sea
SS3-06-S	Xiufeng Zhao	Abundance and sinking of biogenic silica in Daya Bay, Northern South China Sea
SS3-07	Yifan Zhu	Silicate dynamic during the degradation of cyanobacterium <i>Synechococcus</i> in the oligotrophic seawater

No.	Presenter	Poster Title
SS3-08-S	Kuanbo Zhou	Temporal response of carbon and silica export to the cyclonic eddies at the Hawaii Ocean Time Series station
SS4-01-S	Rongrong Cen	An isotopic perspective to estimate fluxes of the aerosol dust deposition in the South China Sea
SS4-02-S	Lufeng Chen	Methylmercury cycling in the Yellow Sea and Bohai Sea, China: Sources/Sinks and controlling factors
SS4-03	Seunghye Han	Methylmercury mass budgets and its distribution characteristics in the Western Pacific Ocean: Application of excitation-emission matrix fluorescence spectroscopy
SS4-04	Yu Hu	The geochemical cycling of redox-sensitive elements at cold seep systems
SS4-05	Huijun He	The conservative behavior of Rare earth elements along the salinity gradient in the Changjiang Estuary-East China Sea interface
SS4-06	Kafayat Adebola Oludare	Distribution of trace elements in surface water and sediments from warri river at the Atlantic ocean observatory 12, delta state of Nigeria ; A two years study
SS4-08-S	Yanli Liu	Rare earth element speciation and changes in core sediments of the East China Sea Shelf: sources, biogeochemical processes and environmental implication
SS4-09-S	Xiangming Shi	Methylmercury flux from sediment: Insights from comparison between $^{224}\text{Ra}/^{228}\text{Th}$ disequilibrium and core incubation
SS4-12-S	Chenhe Zheng	Responses of trace element composition to the growth and metabolism of marine micro - organisms and its marine ecological significance
SS5-01-S	Binhe Luo	Influence of Ural and European blocking on Arctic sea ice loss.
SS5-02	Changjian Liu	The observation and analysis of eastern Guangdong coastal downwelling in winter, 2006
SS5-03	Yu-Hsin Cheng	Interannual variability of summer cold dome northeast of Taiwan
SS5-04-S	Tianfeng Guo	Concentration and size distribution of particulate oxalate in marine and coastal atmosphere Implication for the increased importance of oxalate in nanometer atmospheric particles
SS5-06-S	Ju Huang	Comparative analysis for impacts of ENSO and Arctic Sea ice reduction on the extreme winter cold events in China
SS5-07-S	Xianting Huang	Vertical structure of recent Arctic warming and the impact of blocking
SS5-08-S	Jinghui Li	Application of an EnOI in Beijing Climate Center Climate System Model (BCC_CSM): Twin experiments for assimilating sea surface data and T/S profiles
SS5-09-S	Muyuan Li	Research for the impact of different kinds of blocking highs on the rainfall distribution in China
SS5-10	Siwei Li	Ten-year aerosol trend over the United States associated with ENSO, NAO and anthropogenic activities
SS5-11-S	Wenyuan Li	North Pacific gyre oscillation and the decadal variability of the Kuroshio extension

No.	Presenter	Poster Title
SS5-13	Qinyan Liu	Thermal variations in the South China Sea associated with the eastern and central Pacific El Nino events and their mechanisms
SS5-14	Anthony Banyouko Ndah	New Perspectives on the sun–ocean–climate connection and long term climatic predictions in the South East Asian Monsoon Region
SS5-15	Yun Qiu	The asymmetric influence of the positive and negative IOD events on China’s rainfall
SS5-17-S	Lingxia Wang	Interannual-to-decadal variability and trends of oceanic barrier layers in tropical areas
SS5-19-S	Yanxin Wang	Strength variability of the Kuroshio Extension sea surface temperature front
SS5-20-S	Xia Zhang	Spatiotemporal characteristics of evapotranspiration variation across global dry land during 1982–2011
SS5-21-S	Xiaodan Chen	The impact of winter Ural blocking on Arctic sea ice
SS5-22	Xiaopei Lin	Dynamics of changing impacts of tropical Indo-Pacific variability on Indian and Australian rainfall
SS5-23-S	Yan Zhang	The contrast of biological and oceanographic elements in terms of vertical distribution and diurnal cycle over the southern slope of the South China Sea
SS5-24	Xiaoyi Yang	Dynamical link between the Barents-Kara Sea ice and the Arctic Oscillation
SS5-26-S	Pengkun Dai	Observation and analysis of typhoon Meranti by multiple satellite sensors
SS6-01-S	Chang Hang	Three-dimensional numerical simulation of M2 internal tides northeast of Taiwan
SS6-02-S	Linan Weng	Estimating turbulence properties in the seas surrounding Taiwan
SS6-03-S	Baolan Wu	Vertical variability of currents revealed by mooring observation
SS7-01-S	Shuhao Li	Flood management in Shanghai
SS7-03	Jiaping Wu	Coastal reclamation: A global comparison
SS7-04-S	Cui Zhang	Scenario analysis for sustainable development of Chongming island: Water resources sustainability
SS7-05-S	Ting Zhang	Assessment of migratory waterfowl habitat status in Shanghai coastal region
SS7-06	Youhua Chen	An introduction on algorithms and software for prioritizing marine protected areas
SS7-07	Bo Tian	Assessment of migratory waterfowl habitat status in Shanghai coastal region
SS8-01	Xianghong Fang	Popular science education of marine science and technology at Tongji Primary School
SS8-02	Yumeng Liu	Discussion on the marine-science public education mode based on Deep-Sea Exploratorium at Tongji University
SS8-03	Daidu Fan	The first decadal review of marine-science outreach activities at Tongji University

Note: IDs that end with -S are poster presented by graduate students.

Local Information and Contacts

Venue

XMAS-III will be held at the **Science and Art Center** on the Siming Campus of Xiamen University (XMU). The Siming Campus is located in Siming District, at the south point of Xiamen Island.

For detailed information on how to get to the hotels and how to get to the meeting venue, please check <http://mel.xmu.edu.cn/conference/3xmas/logistics.asp?id=94>.





An aerial view of Xiamen University's Siming Campus and hotels



Map of Xiamen University's Siming Campus

Housing

Accommodations are reserved at four different locations. Please check the form below for detailed information. For assistance on hotel booking, please contact Xinya Xu(xuxinya@xmu.edu.cn, 15860721810).

Hotel	Millennium Harbourview Hotel 海景千禧酒店	XMU Campus Hotels 厦门大学学术交流中心	Green Tree Inn 格林豪泰酒店	Swiss International Hotel 瑞颐大酒店
Breakfast	Yes	Yes	Yes	Yes
Internet	Yes	Yes	Yes	Yes
Commute type	Shuttle bus provided	Walk distance	Walk distance	Bus or taxi
Commute time	~20 mins	~5 mins	~10 mins	~20 mins
Address	12-8 ZhenHai Rd. 思明区镇海路 12 号之 8 号	422 South Siming Rd. Siming Campus, XMU 思明区思明南路 422 号(厦大思明校区内)	13 XiaWoZai Str., 思明区下沃仔 13 号(厦大西门对面)	12 Lu Jiang Dao, 思明区鹭江道 12 号
Phone	86-592-2023333	86-592-2182623	86-592-2353333	86-592-6366666

Wi-Fi Connection Instructions

- ✧ Wi-Fi in the Science and Art Center provided, the username is keyi, and password is aabbccdde.
- ✧ The XMU wireless network now covers the entire XMU campus. XMU faculty and students can go directly to <http://inc.xmu.edu.cn/wids/> to reset your Wi-Fi code. For questions: 2183508、2181259.

Contacts for Logistics

Logistics	Secretary	Email	Cell phone +86-
Coordinator	Angela Liu	huiliu@xmu.edu.cn	13400657090
Facilities & website	Zhaoying Li	lizhaoying@xmu.edu.cn	13860473552
Meal	Mengmei Lin	mel@xmu.edu.cn	13599531566
Fee payment	Qingmei Lin	lqm@xmu.edu.cn	13666034554
Visa& English Editor	Emily King	ehk.cosee.china@outlook.com	15860721810
Tickets	Suwei Weng Yan Yang	wengsuwei@xmu.edu.cn yanyang@xmu.edu.cn	13720887781 13806028054
Registration & Volunteer	Vera Shi Tinglin Yang	vera_shiwei@xmu.edu.cn tinglin@xmu.edu.cn	13950003935 13515964262
Housing & Transportation	Xinya Xu	xuxinya@xmu.edu.cn	18005960255
Exhibition & Poster	Jun Zhang	junzhang@xmu.edu.cn	13860426122

微型光谱仪 生化应用

制药行业

原辅料/真伪药鉴别
制药过程控制
药物动态溶出度检测



生物医学

疾病原位无损检测
DNA检测
免疫分析

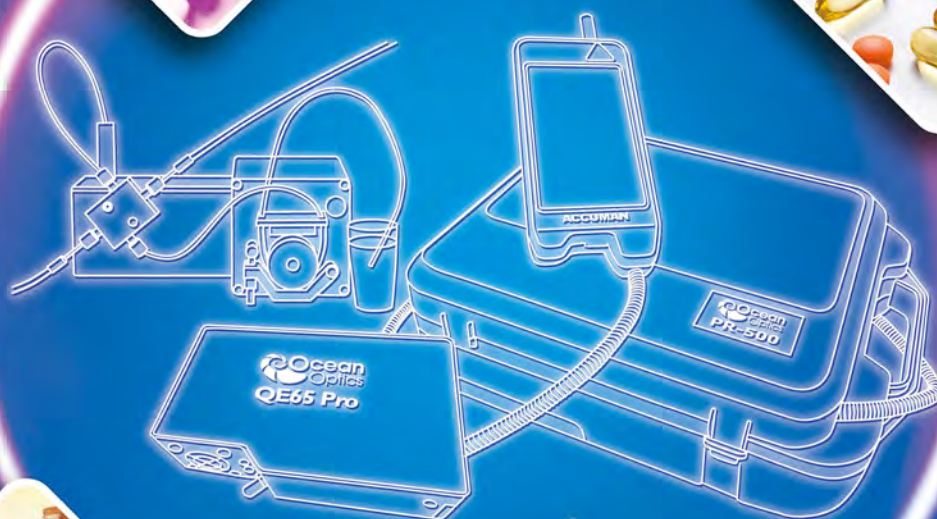
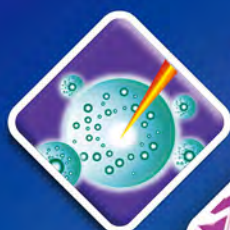

过程监控

制备色谱
微流控
反应监控

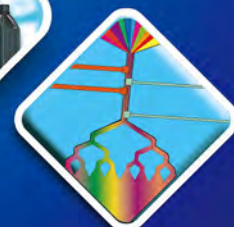

食品安全

非法添加剂检测
供应链控制
营养成分分析



最专业的方案提供者 最优质的系统服务商



“新雪龙”号极地破冰船



厦门大学“嘉庚”号



主要产品：绞车 收放系统 吊机 ROV

近年整船甲板设备项目选摘：

国家海洋局“3000吨级浮标作业船” “广海局综合地质调查船” “新雪龙”号极地破冰船 厦门大学
“嘉庚”号科学考察船 “向阳红 01”号科学考察船 “向阳红 03”号科学考察船 “向阳红 10”
号科学考察船 “探索一号”科学考察船



广州鸿海海洋专用设备有限公司

Honghai Marine Co., Ltd.

地址：广州市番禺区番禺大道北 555 号天安科技园创业中心 509 室 (PC:511430)

电话：020 39218982 39218983 传真：020 39122069

网址：www.honghaimarine.com 邮箱：deckgears@honghaimarine.com

公司成立于1998年10月，公司总部坐落于美丽的鹭岛城市——厦门，多年来专注于在线水质监测仪表行业，赢得广大代理商及用户的信赖，同时也博得了国际生产商的肯定。我们始终将产品质量与服务质量放在首位我们通过定期的技术培训、产品知识培训来提高人员的专业知识和技术水平，专业为您提供售前、售后技术服务。

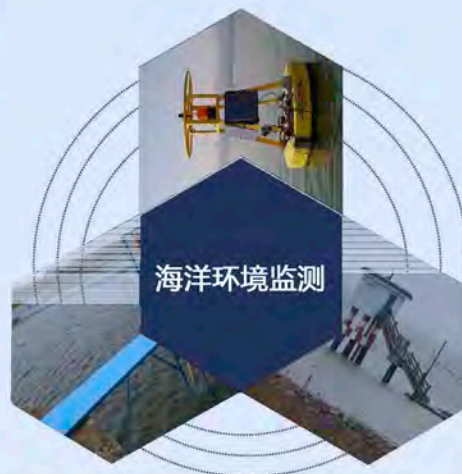

原位营养盐监测分析仪



型号：KLD-C-Probe



KLD-C Probe 原位营养盐水质分析仪 是一种在线浮标式多参数水质分析仪，用于测量地表水、海水中的营养物质，可测量氨氮 ($\text{NH}_3\text{-N}$)、磷酸盐 ($\text{PO}_4\text{-P}$)、总磷 (TP)、硝氮 ($\text{NO}_3\text{-N}$)、亚硝氮 ($\text{NO}_2\text{-N}$)、总氮 (TN) 等其他参数。

潮位站自动化监测站



型号：KLD-C-System



该系统是为潮位站海水水质监测而开发的一种小型自动化监测系统，可测定pH 温度DO 盐度 叶绿素a 五项营养盐等参数，系统含有过滤系统、PLC控制系统、传输系统、水质监测设备。

应用领域：潮位站、陆源入海口

陆源入海口在线间断分析仪



型号：KLD-Chem



全自动在线间断化学分析技术具有高度实现在线测试的自动化、智能化及批量化分析。最大可测定260个样品。监测参数：氨氮、亚硝酸盐、硝酸盐、磷酸盐、硅酸盐、硫化物、氟离子、六价铬、铁、锌、硫酸盐等。

应用领域：陆源入海口、水源地监测、流域监测、污染源监测

厦门市吉龙德环境工程有限公司

地址：厦门市集美区杏林湾商务营运中心3#704

电话：0592-5919855/18859204134

传真：0592-5915855

全国服务热线：400-9185800

E-Mail: kelungde@163.com

网址: www.kelungde.com



物理海洋

仪器设备

Physical Oceanology
Instruments

Satlantic公司产品主要包括硝酸盐测量仪、pH测量仪、叶绿素荧光分析仪、辐射测量仪等海洋化学和光学仪器。图为Profiler II型自由落体式水色剖面测量仪。

Wet Labs公司产品主要包括吸收衰减仪、透射计、散射计、荧光计等海洋光学仪器。图为AC-S型高光谱水体吸收/衰减系统。

Sea-Bird Electronics公司产品主要包括剖面式、定点式和船载走航式温盐深测量仪，以及多瓶采水器、感应耦合传输系统，Argo浮标等。

Teledyne RDI公司产品主要包括多普勒流速剖面仪、多普勒计程仪等。适合锚系式、坐底式和船载走航式等多种调查方式。

劳雷工业公司长期致力于海洋调查及地球物理仪器的应用研究，系统集成，新产品开发，市场营销，售后技术服务及工程技术咨询服务。长期活跃在科学调查，资源勘探，工程检测和环境保护领域，在北京、上海、香港、美国均设有分公司/代表处/及维修站。用最先进的科学技术手段和最新的应用科学方法为市场和客户提供完整的技术方案，推动前沿学科快速发展是公司的战略方针。劳雷工业公司成功地向市场推出了许多首创的勘探调查仪器系统，帮助支持成百上千的用户完成了许多重大国家科学项目和工程项目。

LAUREL 劳雷海洋系统有限公司
LAUREL TECHNOLOGIES COMPANY LIMITED

北京公司：
北京市朝阳区青年路7号院（达美中心）
1号楼8层
邮编：100025
电话：010-85850088
传真：010-85850087
E-mail: laurel@laureltech.com.cn

上海公司：
上海市徐汇区龙吴路777号10号C室
邮编：200232
电话：021-61196200
传真：021-61196210
E-mail: laurelsh@laureltech.com.cn

成都公司：
四川省成都市青羊区蜀金路1号金沙
万瑞中心C座2109室
邮编：610091
电话：028-61338015
传真：028-61338025
E-mail: laurelcd@laureltech.com.cn

*更多产品详情请咨询劳雷工业有限公司 (www.laureltechnologies.com)

R2SONIC公司产品主要包括SONIC2026/2024/2022/2020型宽带超高分辨率多波束测深仪，代表了当前世界最先进的水下声学技术。图为SONIC 2026型多波束测深仪。



GT-2M海洋重力仪采用智能控制平台，并有4个可编程滤波器，可同步运行，在恶劣的海况下也能保证数据的高质量采集，且适用各种大小船型。同时，劳雷公司也是Micro-g & LaCoste MGS6型重力仪国内唯一代理商。



Teledyne BlueView公司产品主要包括3D/2D/AUV声呐系统。图为BV5000型水下三维全景成像声呐，可生成水下地形、结构和目标的高分辨率图像。



海洋测绘
仪器设备
Hydrographic Survey
Instruments

EdgeTech公司产品主要包括侧扫声呐、浅地层剖面仪、组合式侧扫（浅剖）、模块化声呐、大型组合式深拖声呐系统等。图为6205测深型侧扫声呐系统，该系统采用EdgeTech新一代测深技术，全面提高测深，双频侧扫的集成度。

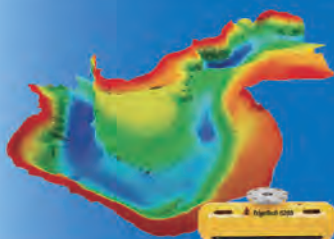

北京普瑞亿科科技有限公司

我公司是一家以经营稳定性同位素分析仪、超痕量气体分析仪、环境气象观测系统、元素分析仪等仪器设备为主，兼顾自主创新研发，致力于为广大用户提供先进仪器设备和成套解决方案的综合性企业。

公司部分产品：



水循环研究 (超高精度液态水和水汽同位素分析仪)



汽态水标配



去除有机物



液态水标配

L2140-i 超高精度液态水和水汽同位素分析仪

- 第四代波长扫描光腔衰荡光谱 (WS-CRDS) 技术
- 最新型的，简单并连续测量 $\delta^{18}\text{O}$ $\delta^{17}\text{O}$ δD 和 ^{17}O 盈余
- 1h 水汽测量 ^{17}O 盈余精度低于 0.015‰
- 重复测量证明液态水中 ^{17}O 盈余的精度是 0.015‰

其他型号：L2130-i、L2120-i

碳氮循环研究 (碳氮同位素、温室气体)



G4301 便携式 CO_2 CH_4 H_2O 分析仪

- 新一代超轻便、电池供电的温室气体分析仪
- 质轻 (11.3KG)，功耗低(25W)
- 内置电池，长达 8 小时连续测量

G2508 CO_2 CH_4 N_2O NH_3 H_2O 分析仪



G5131-i N_2O 浓度及 $^{18}\text{O}/^{15}\text{N}$ 稳定同位素比率分析仪

- 同时测量 N_2O 及 ^{15}N -Alpha, ^{15}N -Beta, ^{18}O 含量
- 小测量腔室，可测量低流速且响应快速
- 结果输出简单实用

G2201- CO_2 CH_4 同位素分析仪



TOC-CRDS 碳同位素分析仪

- 一套系统准确测量 TIC, TOC 和 $\delta^{13}\text{C}$ 等参数
- 完整的固体、液体和气体碳同位素解决方案
- ppb 级超高灵敏度、精确度和准确度，基本无漂移

痕量气体 \元素分析 \环境气象 \光谱分析 \土壤观测.....

PRI-ECO 原生态有限公司
Pri-eco Company Limited

地址：北京市海淀区瀚河园路自在香山 159 号楼 2 单元 202 室 100093

电话：(+86)010-51651246 传真：(+86)010-88121891

邮箱：info@pri-eco.com 网址：www.pri-eco.com





厦门天相海洋科技有限公司(实际案例)



客制化 〔2.3 米多参数综合浮标系统〕



AXYS 〔波浪浮球〕

〔移动式光达系统〕



客制化 〔柜式移动洁净分样、分析实验室〕

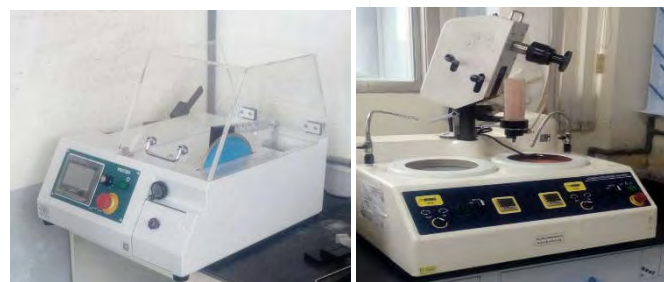

GioJeng 〔精密切割机〕

〔自动研磨机〕



客制化 〔柜式移动大气采样实验室〕 〔移动工具柜〕

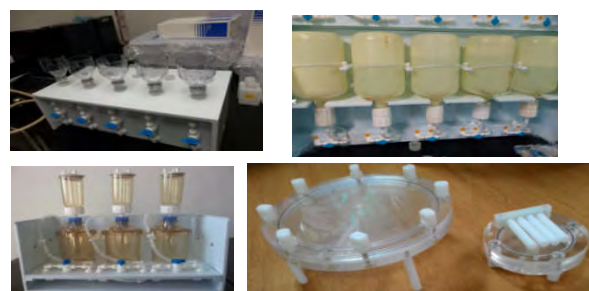

客制化 〔过滤装置〕



客制化 〔斑马鱼培育系统〕 〔低温饲养系统〕



IDRONAUT 〔时间序列剖面多参数检测系统〕

〔多参数温盐深仪 CTD 〕

原位藻类荧光仪 FastOcean APD

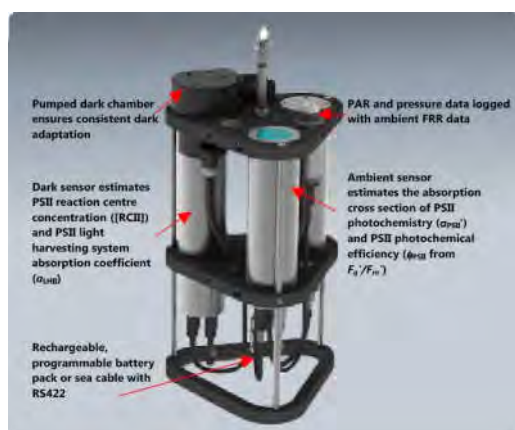

南极地区测量总初级生产力

- 用途：1. 原位测量藻类光合作用中的生理生态参数， F_v/F_m , 有效吸收截面积, 电子传递时间等
2. 估算水体初级生产力

全自动光响应曲线测量系统 FastOcean plus Act2



雪龙号北极航次断面测量

- 用途：1. 实验室培养藻光合作用
2. 大洋科考-断面测量
3. 围隔实验，实现 24 小时全天候测量
4. 估算水体初级生产力

水下拖体

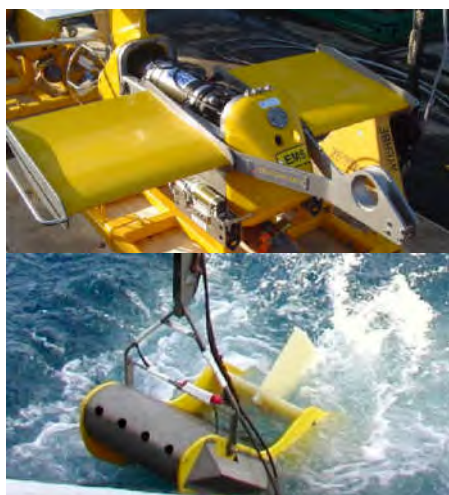

UviLux 传感器



测量参数：
CDOM、碳氢化合物、水中油、色氨酸、BOD5
叶绿素 a、藻蓝蛋白、藻红蛋白、浊度、荧光剂

TriLux 传感器



**The Third Xiamen Symposium on Marine Environmental Sciences
Evaluation**

1) Select one:

___ Professor ___ Student ___ Post-Doc ___ Technician ___ Other (Please specify) _____

2) Please indicate your overall satisfaction with this meeting.

	Very Satisfied	Somewhat Satisfied	Neutral	Somewhat Dissatisfied	Very Dissatisfied
Conference content					
Registration process					
Venue					
Food and Beverage					

3) How would you rate the following:

	Strongly Disagree	Disagree	Neutral	Agree	Strongly Agree
I was notified of the meeting requirements in a timely fashion.					
Overall, the meeting was run on time/schedule.					
The agenda/schedule was clear and concise.					
Information was presented clearly by organizers during the meeting.					
The poster session was well organized.					
The meeting website was kept up-to-date and easy to use.					
I was given ample opportunities to network.					
The student session was a great and useful addition to this meeting.					
It was worth my time to attend this meeting.					
I would be interested in attending future meetings hosted by MEL.					

4) What went well at this meeting?

5) What can we improve for future meetings?

6) Which sessions/topics would you like to see included in the future?

7) Additional comments:

**** Note: Please return this questionnaire to the information desk in the lobby by 18:00 Jan 11. Thank you!**



Organizers and Sponsors



Co-sponsors

